

# Soils Map

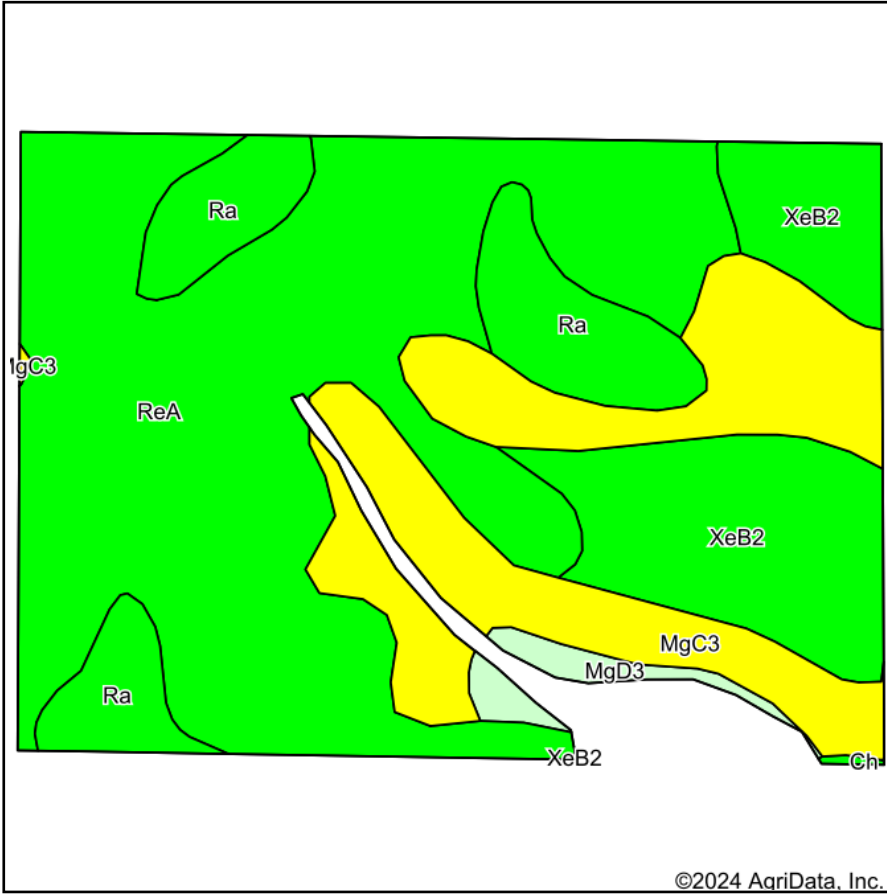

Soils data provided by USDA and NRCS.

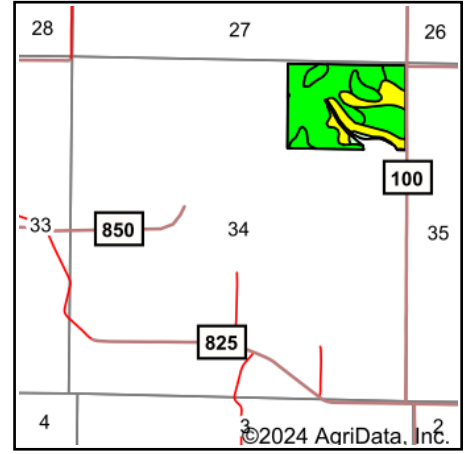

State: **Indiana**  
 County: **Putnam**  
 Location: **27-16N-4W**  
 Township: **Franklin**  
 Acres: **54.04**  
 Date: **3/1/2024**



Maps Provided By:



© AgriData, Inc. 2023

www.AgriDataInc.com



Area Symbol: IN133, Soil Area Version: 25

Code	Soil Description	Acres	Percent of field	Non-Irr Class Legend	Non-Irr Class *c	Corn Bu	Grass legume hay Tons	Kentucky bluegrass AUM	Orchardgrass alfalfa hay Tons	Orchardgrass red clover hay Tons	Pasture AUM	Soybeans Bu	Tall fescue AUM	Winter wheat Bu	*n NCCF Soybean	
ReA	Reesville silt loam, 0 to 2 percent slopes	27.12	50.2%		IIw	161	5	4	5	5	10	53	5	70		
MgC3	Miami clay loam, 6 to 12 percent slopes, severely eroded	11.19	20.7%		IVe	126	4				8	44		56		
XeB2	Xenia silt loam, 2 to 6 percent slopes, eroded	8.69	16.1%		IIe	152	5		1	1	10	53	1	68		
Ra	Ragsdale silt loam, 0 to 2 percent slopes	6.02	11.1%		IIw	185	6				13	56		75		
MgD3	Miami clay loam, 12 to 18 percent slopes, severely eroded	1.02	1.9%		VIe	110	4				7	38		49		
<b>Weighted Average</b>						<b>2.49</b>	<b>154</b>	<b>4.9</b>	<b>2</b>	<b>2.7</b>	<b>2.7</b>	<b>9.9</b>	<b>51.2</b>	<b>2.7</b>	<b>66.9</b>	<b>*n 6</b>

\*n: The aggregation method is "Weighted Average using all components"

\*c: Using Capabilities Class Dominant Condition Aggregation Method

Soils data provided by USDA and NRCS.