

Soils Map

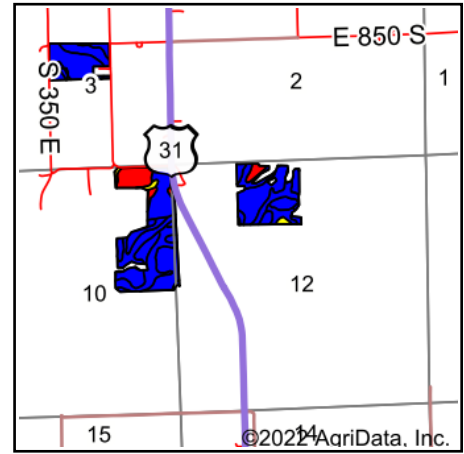

Soils data provided by USDA and NRCS.



State: **Indiana**
 County: **Bartholomew**
 Location: **10-7N-6E**
 Township: **Sand Creek**
 Acres: **115.8**
 Date: **8/19/2022**



Maps Provided By:



© AgriData, Inc. 2021

www.AgriDataInc.com



Area Symbol: IN005, Soil Area Version: 24

Code	Soil Description	Acres	Percent of field	Non-Irr Class Legend	Non-Irr Class *c	Corn Bu	Soybeans Bu
WprAV	Wirt loam, 0 to 2 percent slopes, frequently flooded, very brief duration	37.94	32.8%		IIw	108	38
NpeA	Nineveh sandy loam, 0 to 2 percent slopes	14.98	12.9%		IIIs	105	33
EcyAH	Eel loam, 0 to 2 percent slopes, frequently flooded, brief duration	13.86	12.0%		IIw	120	42
WsuA	Whitaker loam, 0 to 2 percent slopes	12.40	10.7%		IIw	153	51
Mfwa	Martinsville loam, sandy substratum, 0 to 2 percent slopes	10.46	9.0%		Iw	145	51
WaaAW	Wakeland silt loam, 0 to 2 percent slopes, occasionally flooded, very brief duration	8.08	7.0%		IIw	146	44
SldAH	Shoals silt loam, 0 to 2 percent slopes, frequently flooded, brief duration	6.77	5.8%		IIw	125	43
NpeB2	Nineveh sandy loam, 2 to 6 percent slopes, eroded	5.19	4.5%		IIe	101	32
GccAH	Genesee loam, 0 to 2 percent slopes, frequently flooded, brief duration	4.05	3.5%		IIw	119	42
BfbAH	Bellcreek silt loam, 0 to 1 percent slopes, frequently flooded, brief duration	1.26	1.1%		IIIw	133	37
SuoAH	Stonelick fine sandy loam, 0 to 2 percent slopes, frequently flooded	0.81	0.7%		IIIw	94	33
Weighted Average					1.93	121.1	40.9

*c: Using Capabilities Class Dominant Condition Aggregation Method
 Soils data provided by USDA and NRCS.