

Soils Map

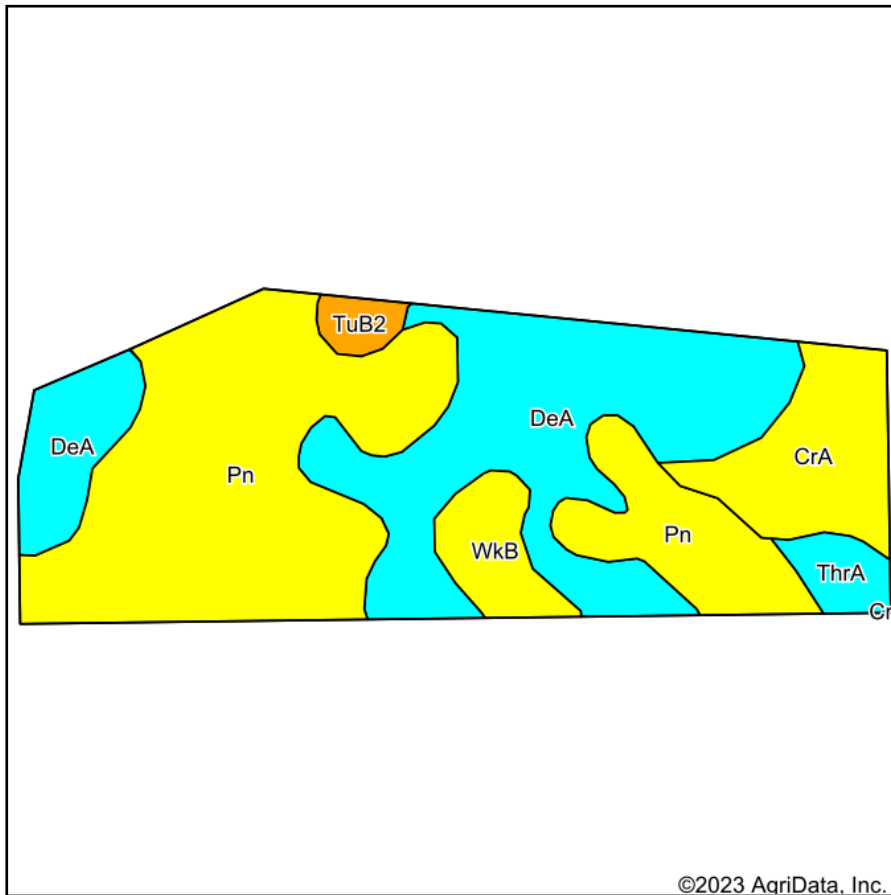

Soils data provided by USDA and NRCS.

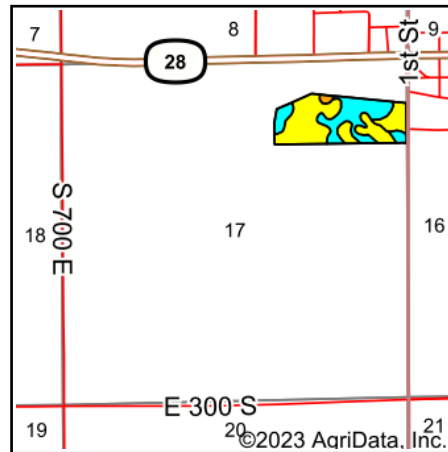

State: **Indiana**
 County: **Tipton**
 Location: **17-21N-6E**
 Township: **Madison**
 Acres: **31.5**
 Date: **7/3/2023**



Maps Provided By:



© AgriData, Inc. 2023

www.AgriDataInc.com



Area Symbol: IN159, Soil Area Version: 22

Code	Soil Description	Acres	Percent of field	NCCPI Overall Legend	Soil Drainage	Non-Irr Class *c	Corn Bu	Pasture AUM	Soybeans Bu	Winter wheat Bu	*n NCCPI Overall
Pn	Patton silty clay loam, 0 to 2 percent slopes	14.07	44.7%		Poorly drained	IIw	173	12	51	71	76
DeA	Del Rey, sandy substratum-Crosby silt loams, 0 to 2 percent slopes	11.24	35.7%		Somewhat poorly drained	IIw	127	8	42	57	79
CrA	Crosby silt loam, fine-loamy subsoil, 0 to 2 percent slopes	3.29	10.4%		Somewhat poorly drained	IIw	154	10	51	69	64
WkB	Williamstown silt loam, 2 to 6 percent slopes, eroded	1.53	4.9%		Moderately well drained	Ile	142	9	48	64	66
ThrA	Treaty silty clay loam, 0 to 1 percent slopes	0.83	2.6%		Poorly drained	IIw	181	12	64	61	82
TuB2	Tuscola, till substratum-Strawn complex, 1 to 6 percent slopes, eroded	0.54	1.7%		Moderately well drained	Ile	135	9	47	64	56
Weighted Average						2.00	152.7	10.2	47.9	65.1	*n 75.1

*n: The aggregation method is "Weighted Average using all components"

*c: Using Capabilities Class Dominant Condition Aggregation Method

Soils data provided by USDA and NRCS.