

Soils Map

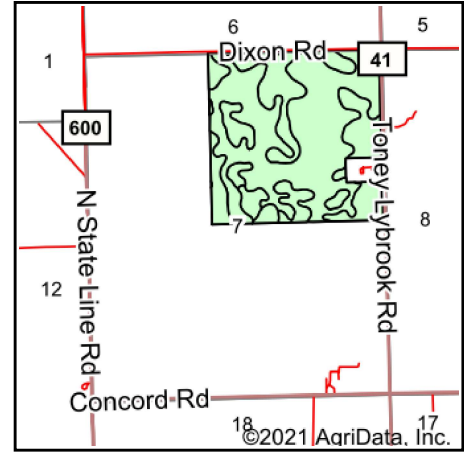

State: **Ohio**
 County: **Preble**
 Location: **7-7N-1E**
 Township: **Dixon**
 Acres: **158.7**
 Date: **12/20/2021**

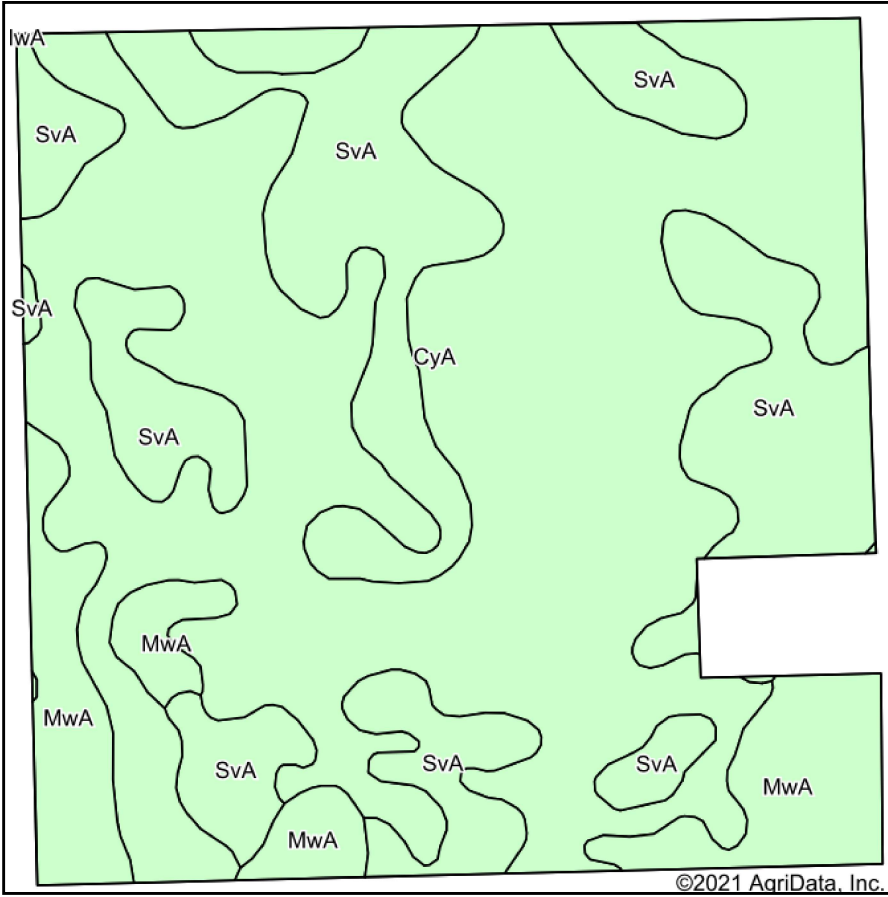

Maps Provided By:



Area Symbol: OH135, Soil Area Version: 20

Code	Soil Description	Acres	Percent of field	Non-Irr Class *c	Corn Bu	Grass legume hay Tons	Kentucky bluegrass AUM	Orchardgrass alfalfa hay Tons	Orchardgrass red clover hay Tons	Pasture AUM	Soybeans Bu	Tall fescue AUM	Winter wheat Bu	*n NCCPI Soybeans	*eFO PI
CyA	Cyclone silt loam, 0 to 2 percent slopes	93.94	59.2%	IIw	185	6.1				12.2	65		75	79	
SvA	Sugarvalley silt loam, 0 to 2 percent slopes	47.32	29.8%	IIw	145		3.8	5.8	6		49	4.5	65	81	
MwA	Morningsun silt loam, 0 to 2 percent slopes	17.44	11.0%	I	148		3.8	5.8	6		52	4.5	68	87	
Weighted Average				1.89	169	3.6	1.6	2.4	2.4	7.2	58.8	1.8	71.2	*n 80.5	

*efotg PI: Obtained from the NRCS eFOTG (<http://efotg.sc.egov.usda.gov>)

*n: The aggregation method is "Weighted Average using all components"

*c: Using Capabilities Class Dominant Condition Aggregation Method

Soils data provided by USDA and NRCS.