

# Soils Map

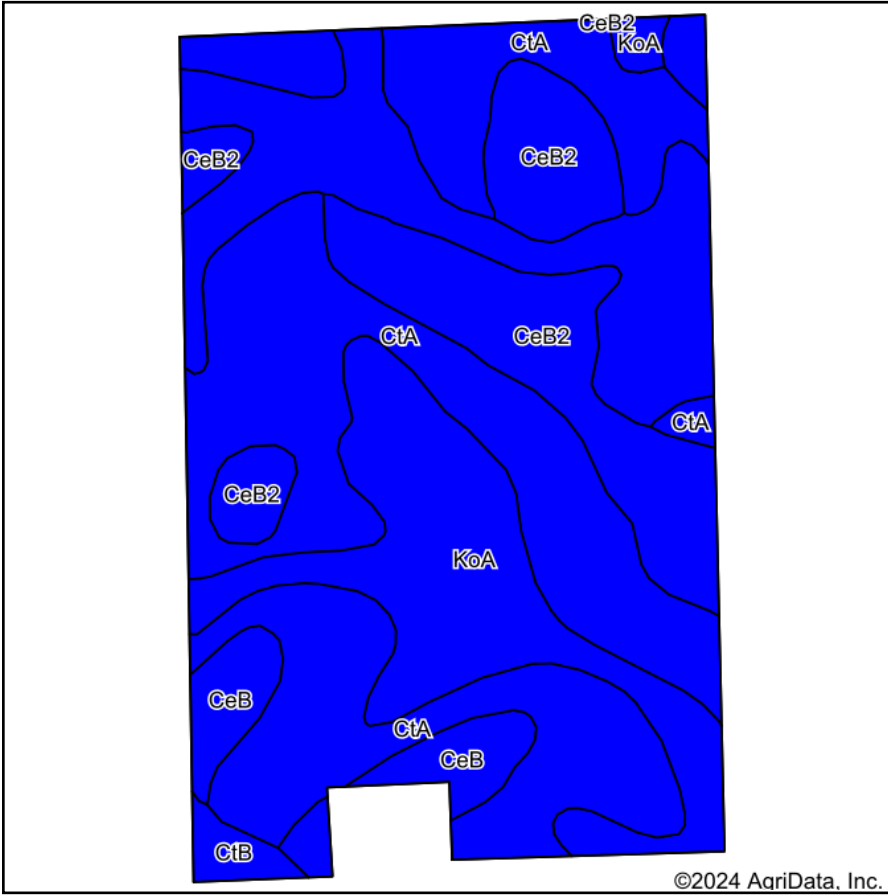

©2024 AgriData, Inc.

Soils data provided by USDA and NRCS.

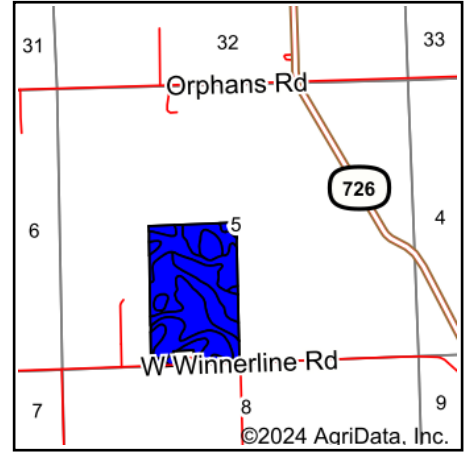

©2024 AgriData, Inc.

State: **Ohio**  
 County: **Preble**  
 Location: **5-8N-2E**  
 Township: **Washington**  
 Acres: **60.61**  
 Date: **7/16/2024**



Maps Provided By:



© AgriData, Inc. 2023

www.AgriDataInc.com



Area Symbol: OH135, Soil Area Version: 22

Code	Soil Description	Acres	Percent of field	Non-Irr Class Legend	Non-Irr Class *c	Alfalfa hay Tons	Corn Bu	Grass legume hay Tons	Kentucky bluegrass AUM	Oats Bu	Orchardgrass alfalfa hay Tons	Orchardgrass red clover hay Tons	Pasture AUM	Soybeans Bu	Tall fescue AUM
CtA	Crosby-Celina silt loams, 0 to 2 percent slopes	26.78	44.2%		Ilw		139	4.6					9.1	46	
KoA	Kokomo silty clay loam, 0 to 1 percent slopes	19.11	31.5%		Ilw		168	5.5					11	49	
CeB2	Celina silt loam, 2 to 6 percent slopes, eroded	10.99	18.1%		Ile	4	115	4.3	3.6	74.2	5	4.4	8	39	5.5
CeB	Celina silt loam, 2 to 6 percent slopes	3.01	5.0%		Ile		131	4.3		70			8.7	46	
CtB	Crosby-Celina silt loams, 2 to 4 percent slopes, eroded	0.72	1.2%		Ilw		130	4.5					8.9	43	
<b>Weighted Average</b>					<b>2.00</b>	<b>0.7</b>	<b>143.3</b>	<b>4.8</b>	<b>0.7</b>	<b>16.9</b>	<b>0.9</b>	<b>0.8</b>	<b>9.5</b>	<b>45.6</b>	<b>1</b>

\*eftog PI: Obtained from the NRCS eFOTG (<http://efotg.sc.egov.usda.gov>)

\*n: The aggregation method is "Weighted Average using all components"

\*c: Using Capabilities Class Dominant Condition Aggregation Method

Soils data provided by USDA and NRCS.