

# Soils Map

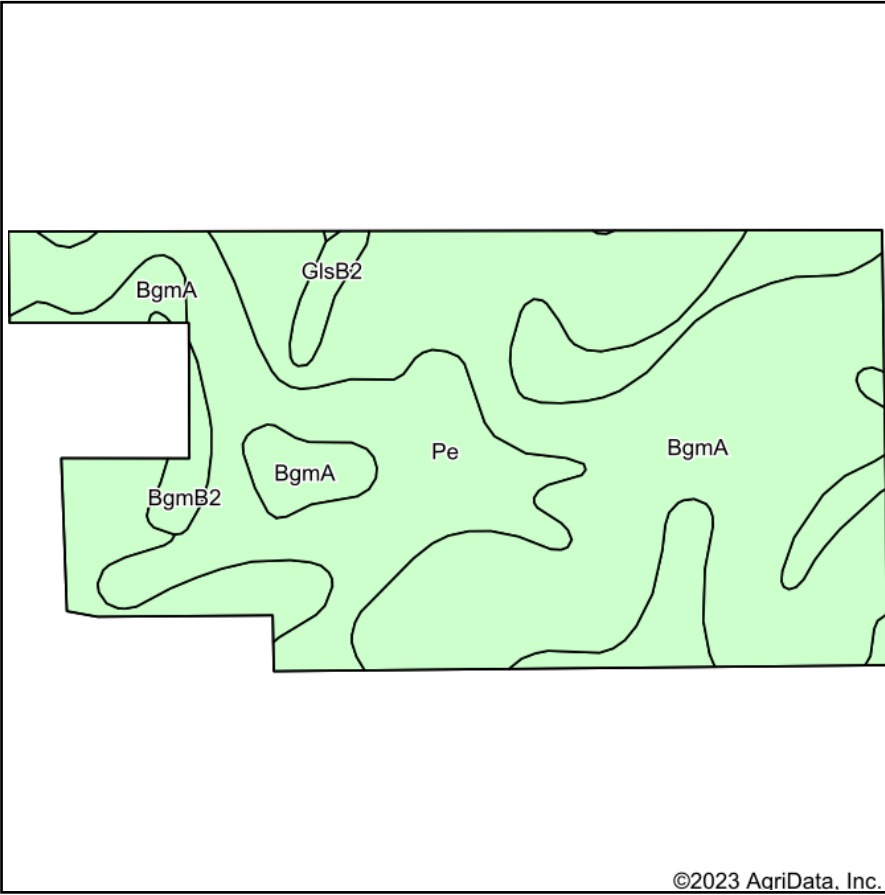

Soils data provided by USDA and NRCS.

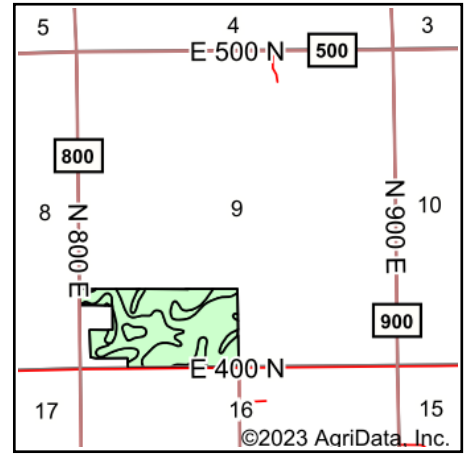

State: **Indiana**  
 County: **Howard**  
 Location: **9-24N-5E**  
 Township: **Liberty**  
 Acres: **69.31**  
 Date: **9/24/2023**



Maps Provided By:



Area Symbol: IN067, Soil Area Version: 27

Code	Soil Description	Acres	Percent of field	Soil Drainage	Non-Irr Class *c	Corn Bu	Soybeans Bu	Winter wheat Bu
BgmA	Blount silt loam, ground moraine, 0 to 2 percent slopes	43.65	63.0%	Somewhat poorly drained	IIw	141	45	63
Pe	Pewamo silty clay loam, 0 to 1 percent slopes	23.63	34.1%	Very poorly drained	IIw	157	47	64
BgmB2	Blount silt loam, ground moraine, 1 to 4 percent slopes, eroded	1.10	1.6%	Somewhat poorly drained	Ile	137	44	61
GlsB2	Glynwood silt loam, ground moraine, 2 to 6 percent slopes, eroded	0.93	1.3%	Moderately well drained	Ile	128	44	57
<b>Weighted Average</b>					<b>2.00</b>	<b>146.2</b>	<b>45.7</b>	<b>63.2</b>

\*c: Using Capabilities Class Dominant Condition Aggregation Method  
 Soils data provided by USDA and NRCS.