

Soils Map

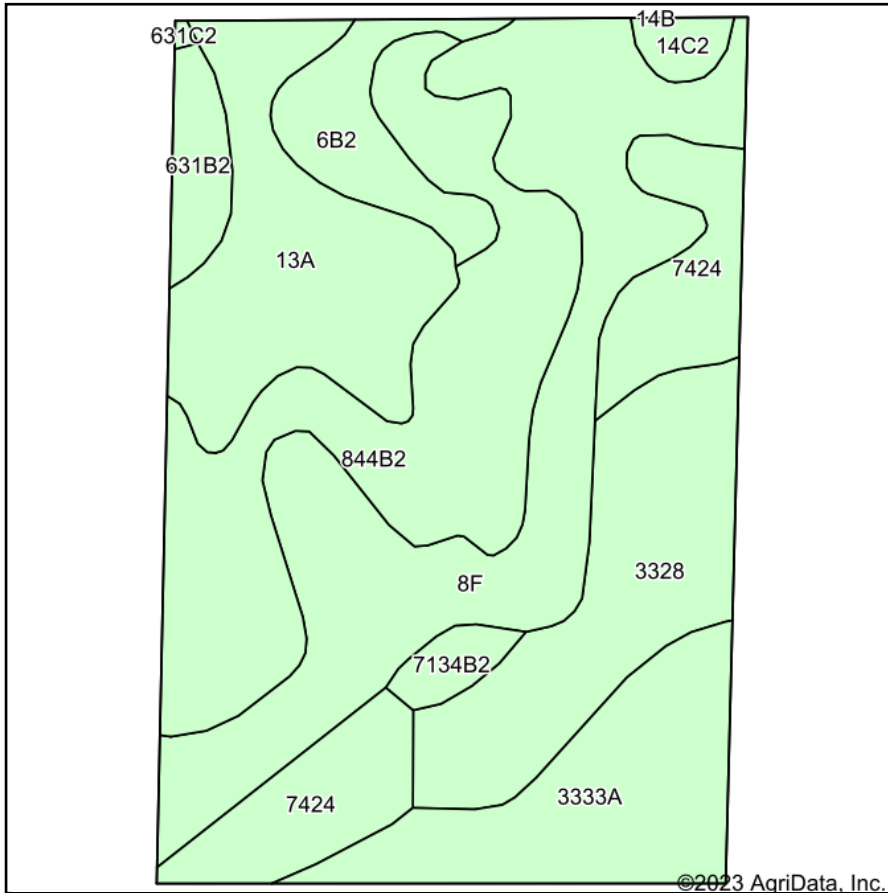

Soils data provided by USDA and NRCS.

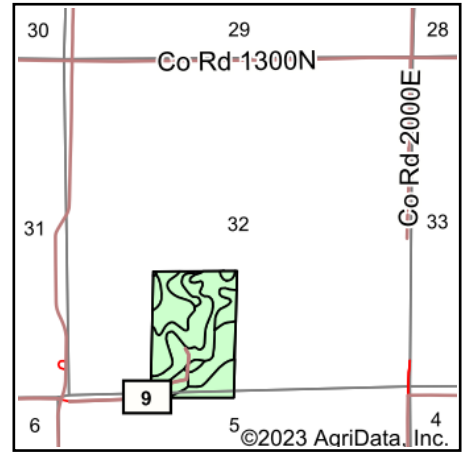

State: **Illinois**
 County: **Cumberland**
 Location: **32-11N-10E**
 Township: **Union**
 Acres: **60**
 Date: **8/4/2023**



Maps Provided By:



© AgriData, Inc. 2023

www.AgriDataInc.com



Area Symbol: IL035, Soil Area Version: 17

Code	Soil Description	Acres	Percent of field	Corn Bu/A
**8F	Hickory silt loam, 18 to 35 percent slopes	14.19	23.6%	**8
**844B2	Ava-Blair complex, 2 to 7 percent slopes, eroded	12.36	20.6%	**12
13A	Bluford silt loam, 0 to 2 percent slopes	7.78	13.0%	13
3328	Holly silt loam, frequently flooded	7.61	12.7%	14
3333A	Wakeland silt loam, 0 to 2 percent slopes, frequently flooded	6.48	10.8%	17
7424	Shoals loam, rarely flooded	5.95	9.9%	17
**6B2	Fishhook silt loam, 2 to 5 percent slopes, eroded	2.77	4.6%	**12
**631B2	Princeton fine sandy loam, 2 to 5 percent slopes, eroded	1.40	2.3%	**14
7134B2	Camden silt loam, 2 to 5 percent slopes, eroded, rarely flooded	0.78	1.3%	16
**14C2	Ava silt loam, 5 to 10 percent slopes, eroded	0.62	1.0%	**12
**631C2	Princeton fine sandy loam, 5 to 10 percent slopes, eroded	0.06	0.1%	**13
			Weighted Average	131.2

Table: Optimum Crop Productivity Ratings for Illinois Soil by K.R. Olson and J.M. Lang, Office of Research, ACES, University of Illinois at Champaign-Urbana. Version: 1/2/2012 Amended Table S2 B811

Crop yields and productivity indices for optimum management (B811) are maintained at the following NRES web site: <http://soilproductivity.nres.illinois.edu/>

** Indexes adjusted for slope and erosion according to Bulletin 811 Table S3

Soils data provided by USDA and NRCS. Soils data provided by University of Illinois at Champaign-Urbana.