

**LAND DESCRIPTION**

**For Amie Neal  
12.000 Acres**

Situated in the Southeast Quarter, Section 8, Township 16 North, Range 12 East, Jackson Township, Wayne County, Indiana, being part of a 65.402 acre tract, as described in Instrument No. 2003020997, as recorded in the Wayne County Recorder's Office, as shown on a survey certified by Gordon E. Moore, L.S. 20400025, as Beals-Moore & Associates, Inc., dated 17 April 2025, W.O. 2025-025, Drawing No. C-4837, and being more particularly described as follows;

Commencing at a mag spike found at the northeast corner of said Quarter, in Symond's Creek Road;

thence South 00°06'45" East (bearings are based upon GPS Coordinates, Projection Set: USA/NAD83/Indiana East) 275.00 feet along the east line of said Quarter, in said road, to a mag nail set on the southerly right-of-way of Interstate Route No. 70, also being the POINT OF BEGINNING for the tract herein described, witness a steel right-of-way post found North 89°19'04" West 27.00 feet;

thence South 00°06'45" East 736.97 feet, continuing along said east line, in said road, to a mag nail set, witness an iron rebar set South 89°53'15" West 25.00 feet, (all iron rebars set are 5/8" with a plastic cap stamped Moore 20400025);

thence South 89°53'15" West 688.72 feet, to an iron rebar set;

thence North 00°06'45" West 785.85 feet, to an iron rebar set on the southerly right-of-way of Interstate Route No. 70;

thence South 89°24'11" East 151.32 feet, along said right-of-way line, to a steel right-of-way post found;

thence South 81°48'40" East 302.76 feet, continuing along said right-of-way line, to a steel right-of-way post found

thence South 89°19'04" East 237.85 feet, continuing along said right-of-way line, to the point of beginning, containing 12.000 acres, more or less, as shown on Drawing No. C-4837, dated 17 April 2025, being subject to the right-of-way of Symond's Creek Road, and to all legal easements of record.

This is to certify that the above description and the plat were prepared from a recent survey, and are true and correct to the best of my knowledge and belief.

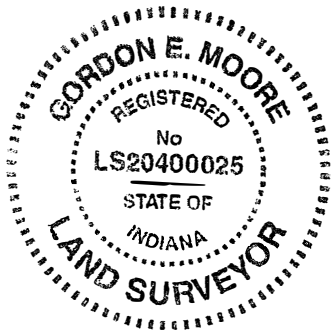

*Gordon E. Moore*  
BEALS-MOORE & ASSOCIATES, INC.  
Gordon E. Moore  
L.S. 20400025  
State of Indiana  
WO 2025-025

*Disclaimer: Alterations of any part of this legal description will render it non-compliant with Indiana Administrative Code Title 865 IAC 1-12.*