

Soils Map

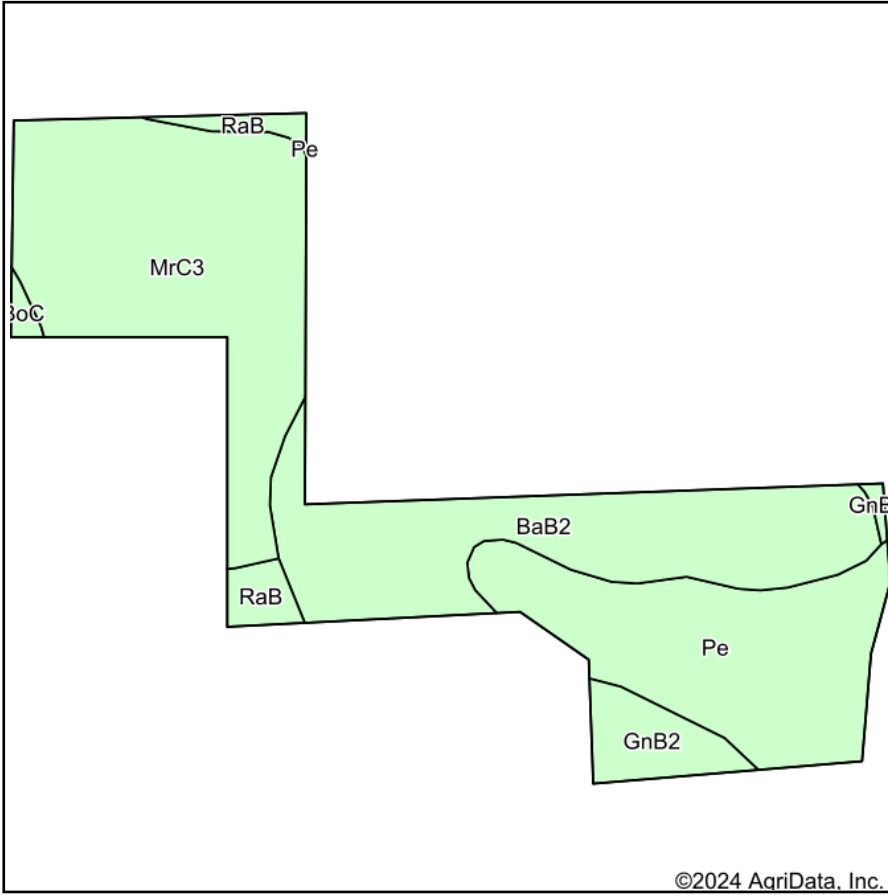

©2024 AgriData, Inc.

Soils data provided by USDA and NRCS.

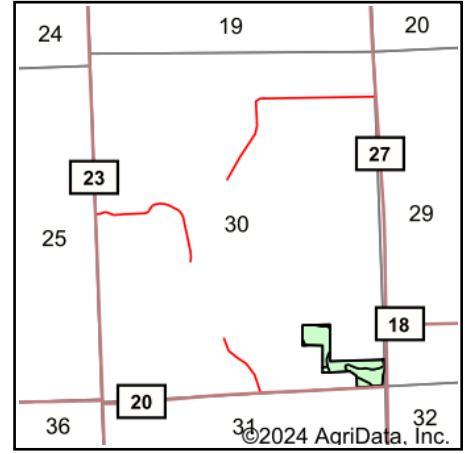

State: **Indiana**
 County: **DeKalb**
 Location: **30-35N-13E**
 Township: **Smithfield**
 Acres: **10.38**
 Date: **9/25/2024**



Maps Provided By:



© AgriData, Inc. 2023

www.AgriDataInc.com



Area Symbol: IN033, Soil Area Version: 28

Code	Soil Description	Acres	Percent of field	Non-Irr Class *c	Irr Class *c	Alfalfa hay Tons	Corn Bu	Corn silage Tons	Grass legume hay Tons	Grass legume pasture AUM	Oats Bu	Pasture AUM	Soybeans Bu	Winter wheat Bu	*n NCCPI Soybeans
MrC3	Morley silty clay loam, 6 to 12 percent slopes, severely eroded	3.79	36.5%	IVe			105	15	4	7			37	47	34
BaB2	Blount loam, interlobate moraines, 1 to 4 percent slopes, eroded	2.94	28.3%	Ile			137	17	5			9	50	54	45
Pe	Pewamo silty clay	2.69	25.9%	IIw			155	22	5			10	42	62	59
GnB2	Glynwood loam, 2 to 6 percent slopes, eroded	0.56	5.4%	Ile		5	128	18	4	8	78		41	56	38

Soils data provided by USDA and NRCS.



Code	Soil Description	Acres	Percent of field	Non-Irr Class *c	Irr Class *c	Alfalfa hay Tons	Corn Bu	Corn silage Tons	Grass legume hay Tons	Grass legume pasture AUM	Oats Bu	Pasture AUM	Soybeans Bu	Winter wheat Bu	*n NCCPI Soybeans
RaB	Rawson sandy loam, 2 to 6 percent slopes	0.33	3.2%	Ile			126	18	5			8	44	57	54
BoC	Boyer sandy loam, 6 to 12 percent slopes	0.07	0.7%	IIle	IIle	3	90	15	3		60	6	30	47	35
Weighted Average				2.74	*-	0.3	128.8	17.6	4.6	3	4.6	5.4	42.4	53.7	*n 44.5

*n: The aggregation method is "Weighted Average using all components"

*c: Using Capabilities Class Dominant Condition Aggregation Method

*- Irr Class weighted average cannot be calculated on the current soils data due to missing data.