

# Soils Map

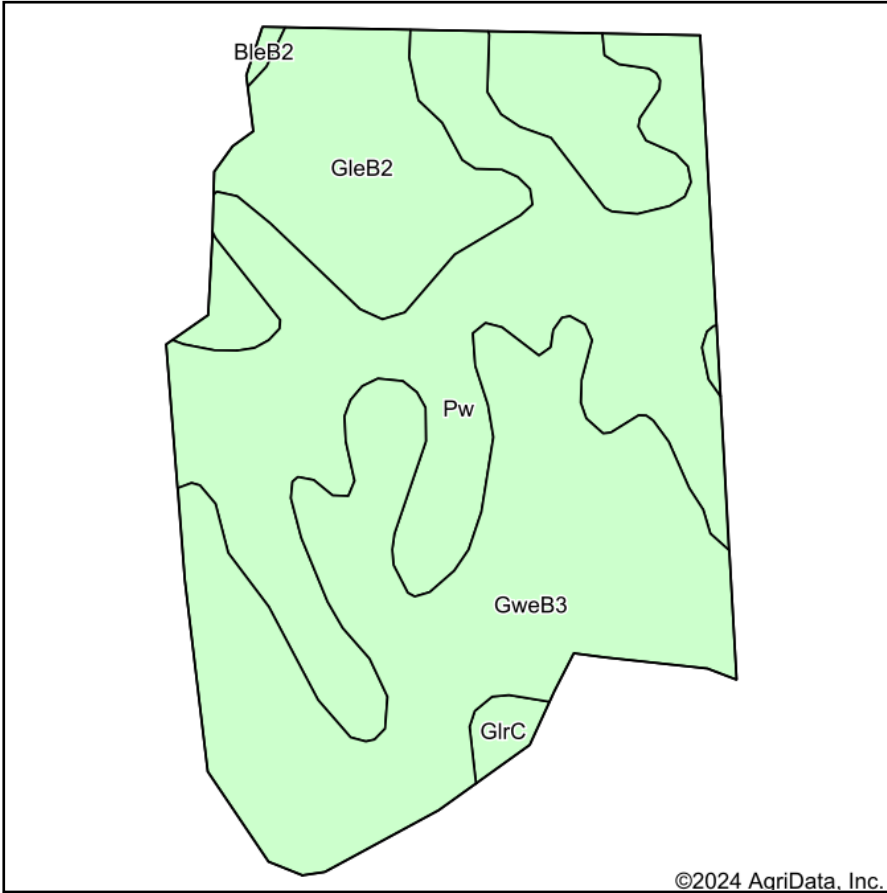

Soils data provided by USDA and NRCS.

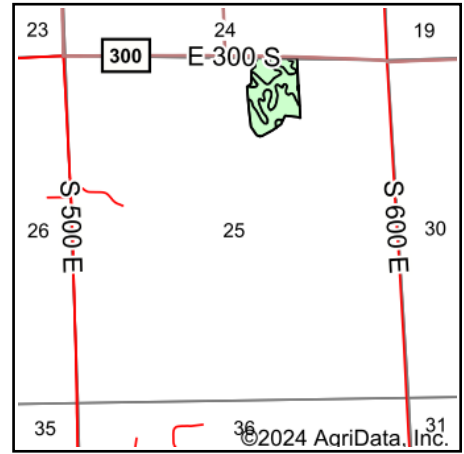

State: **Indiana**  
 County: **Grant**  
 Location: **25-24N-8E**  
 Township: **Mill**  
 Acres: **18.4**  
 Date: **10/21/2024**



Maps Provided By:



Area Symbol: IN053, Soil Area Version: 31

Code	Soil Description	Acres	Percent of field	Non-Irr Class Legend	Non-Irr Class *c	Corn Bu	Soybeans Bu	*n NCCPI Corn	*n NCCPI Soybeans	
GweB3	Glynwood-Mississinewa clay loams, end moraine, 3 to 8 percent slopes, severely eroded	7.27	39.5%		IIIe	120	40	48	30	
Pw	Pewamo silty clay loam, 0 to 1 percent slopes	7.06	38.4%		IIw	157	47	75	66	
GleB2	Glynwood silt loam, end moraine, 1 to 4 percent slopes, eroded	3.86	21.0%		Ile	123	42	55	38	
GlrC	Glynwood silt loam, 6 to 12 percent slopes	0.21	1.1%		IIIe	124	32	69	51	
<b>Weighted Average</b>						<b>2.41</b>	<b>134.9</b>	<b>43</b>	<b>*n 60.1</b>	<b>*n 45.7</b>

\*n: The aggregation method is "Weighted Average using all components"

\*c: Using Capabilities Class Dominant Condition Aggregation Method

Soils data provided by USDA and NRCS.