

# Soils Map

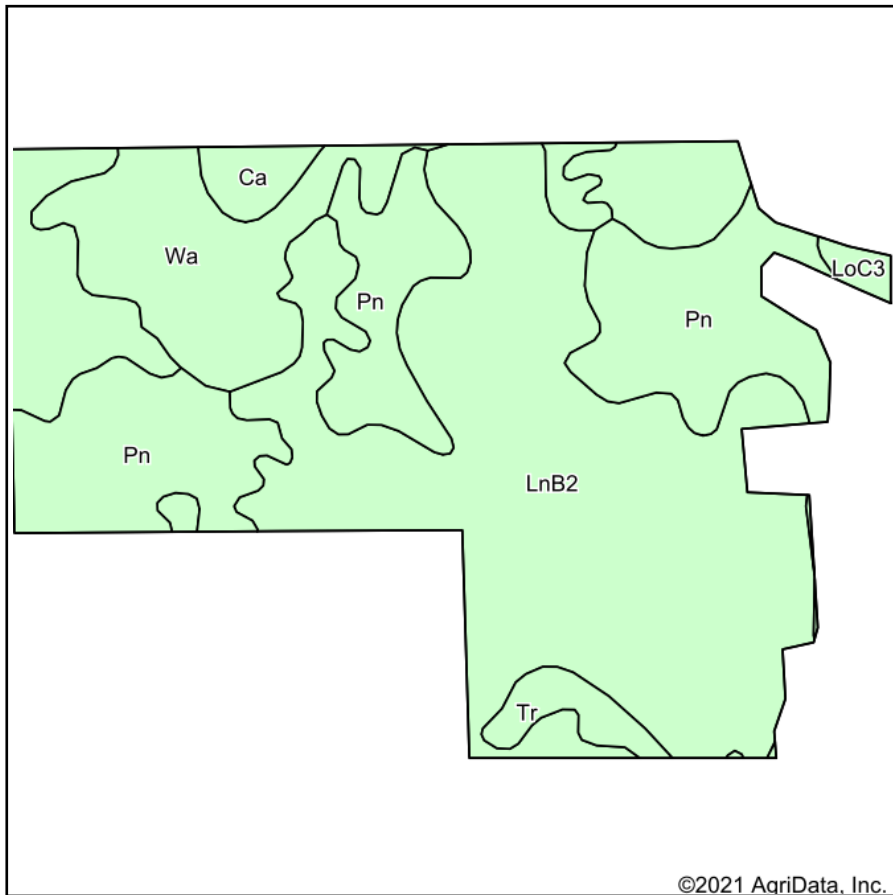

Soils data provided by USDA and NRCS.

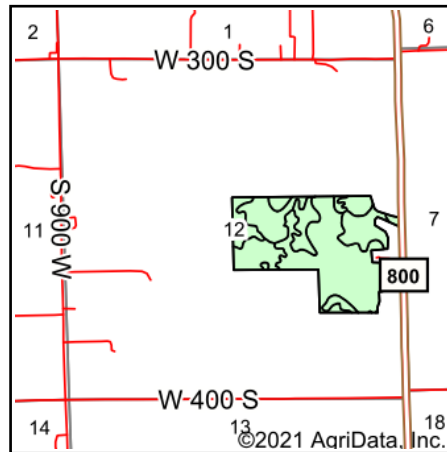

State: **Indiana**  
 County: **Randolph**  
 Location: **12-19N-12E**  
 Township: **Stoney Creek**  
 Acres: **75.74**  
 Date: **12/10/2021**



Maps Provided By:



Area Symbol: IN135, Soil Area Version: 25

Code	Soil Description	Acres	Percent of field	Non-Irr Class *c	Corn Bu	*n NCCPI Soybeans
LnB2	Losantville silt loam, 2 to 6 percent slopes, eroded	43.48	57.4%	Ile	113	25
Pn	Patton silty clay loam, 0 to 2 percent slopes	19.25	25.4%	IIw	172	78
Wa	Walkill silt loam, undrained	9.58	12.6%	Vw		31
Tr	Treaty silt loam, 0 to 2 percent slopes	1.60	2.1%	IIw	177	71
Ca	Houghton muck, undrained, 0 to 1 percent slopes	1.28	1.7%	Vw		
LoC3	Losantville clay loam, 6 to 12 percent slopes, severely eroded	0.55	0.7%	IVe	111	21
<b>Weighted Average</b>				<b>2.44</b>	<b>113.1</b>	<b>*n 39.7</b>

\*n: The aggregation method is "Weighted Average using all components"

\*c: Using Capabilities Class Dominant Condition Aggregation Method

Soils data provided by USDA and NRCS.