

Soils Map

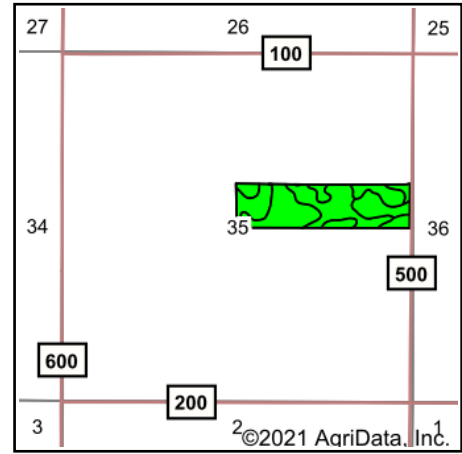

Soils data provided by USDA and NRCS.



State: **Indiana**
 County: **Greene**
 Location: **35-7N-6W**
 Township: **Washington**
 Acres: **39.85**
 Date: **1/29/2021**



Code	Soil Description	Acres	Percent of field	Non-Irr Class Legend	Non-Irr Class *c	Corn	Grass legume hay	Pasture	Soybeans	Winter wheat	*n NCCPI Soybeans
Ay	Ayrshire sandy loam	11.53	28.9%		IIw	150	5	10	49	68	64
Pc	Patton silty clay loam, 0 to 1 percent slopes	10.62	26.6%		IIw	160	5	11	46	64	84
AnB	Alvin-Bloomfield complex, 2 to 6 percent slopes	10.04	25.2%		Ile	99	4	7	35	48	41
Rb	Rensselaer sandy loam	6.32	15.9%		IIw	170	6	11	47	68	78
Rd	Rensselaer loam	1.34	3.4%		IIw	175	6	12	49	70	87
Weighted Average						143.8	4.9	9.7	44.4	62	*n 66.5

*n: The aggregation method is "Weighted Average using all components"

*c: Using Capabilities Class Dominant Condition Aggregation Method

Soils data provided by USDA and NRCS.