

Soils Map

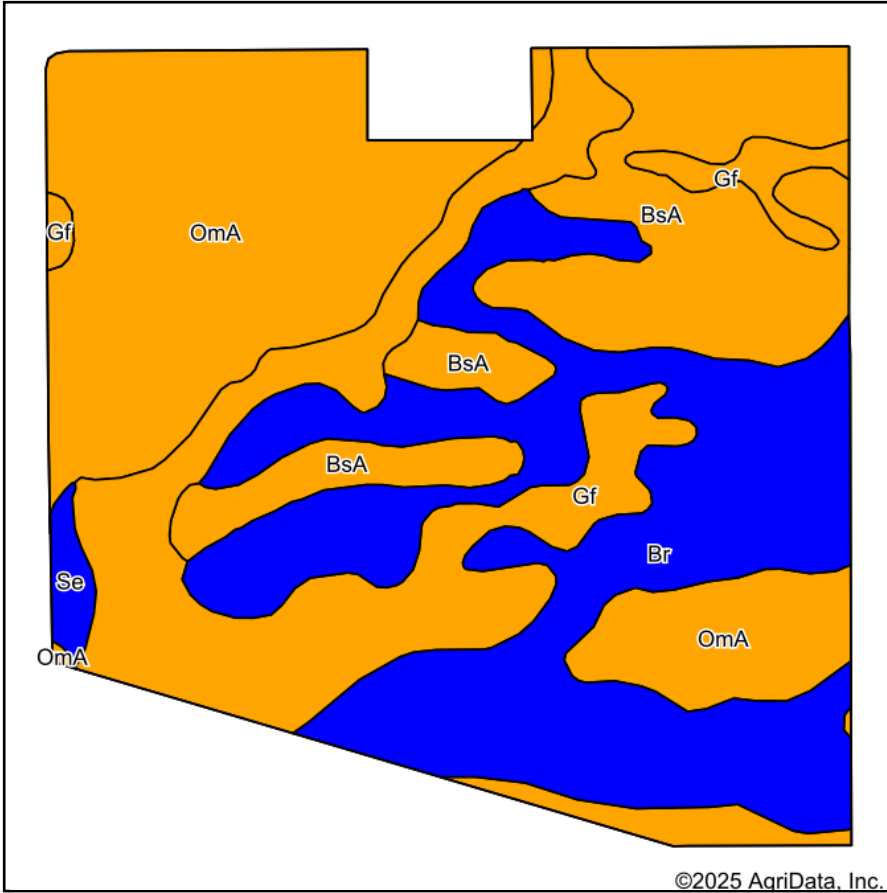

Soils data provided by USDA and NRCS.

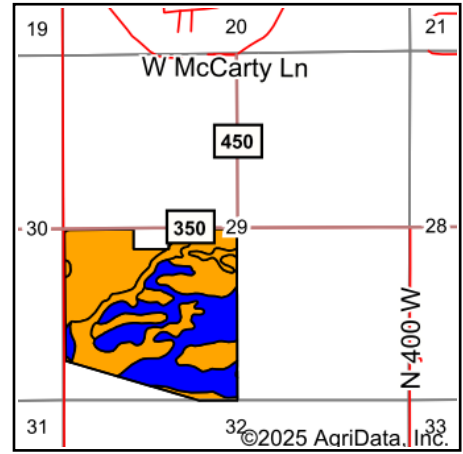

State: **Indiana**
 County: **Fulton**
 Location: **29-31N-2E**
 Township: **Rochester**
 Acres: **140.17**
 Date: **11/7/2025**



Area Symbol: IN049, Soil Area Version: 28

Code	Soil Description	Acres	Percent of field	Non-Irr Class Legend	Non-Irr Class *c	Corn Bu	Soybeans Bu	*n NCCPI Overall	*n NCCPI Corn	*n NCCPI Soybeans
Br	Brady sandy loam	44.86	32.0%		Ilw	124	35	64	64	49
OmA	Ormas loamy sand, 0 to 2 percent slopes	39.00	27.8%		Ills	90	32	61	61	38
Gf	Gilford fine sandy loam, 0 to 2 percent slopes, gravelly subsoil	29.85	21.3%		Illw	150	42	73	73	53
BsA	Branch loamy sand, 0 to 2 percent slopes	25.10	17.9%		Ills	126	44	62	62	39
Se	Sebewa sandy clay loam	1.36	1.0%		Ilw	160	44	60	60	56
Weighted Average						2.67	120.8	*n 64.7	*n 64.7	*n 45.1

*n: The aggregation method is "Weighted Average using all components"

*c: Using Capabilities Class Dominant Condition Aggregation Method

Soils data provided by USDA and NRCS.