

# Soils Map

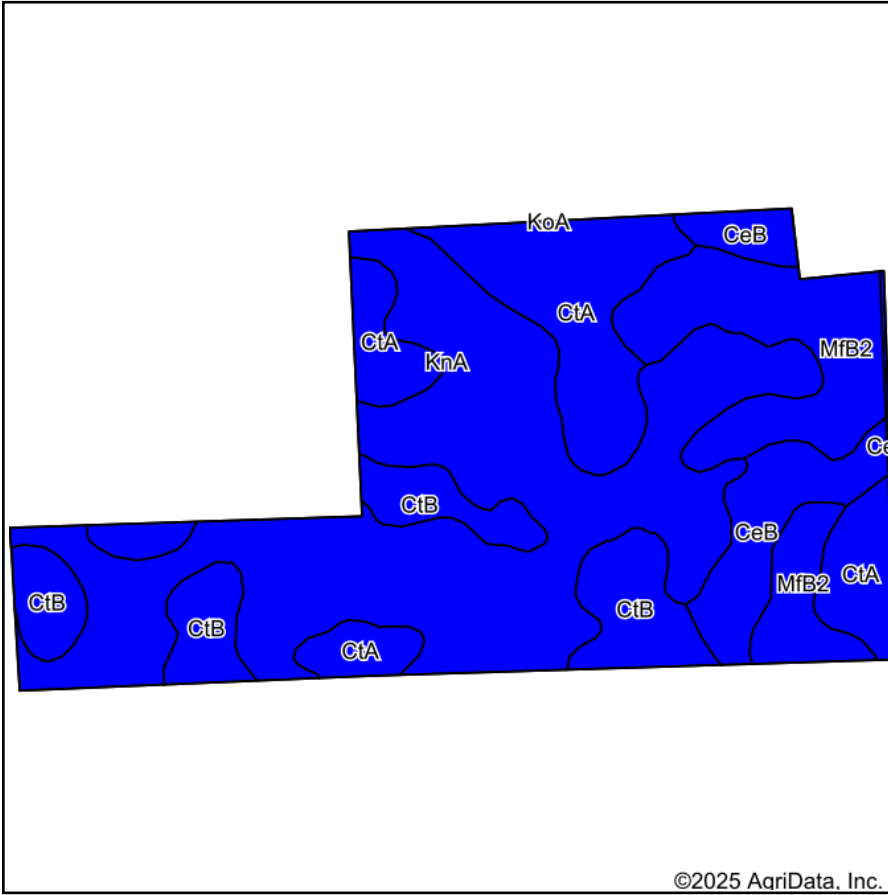

©2025 AgriData, Inc.

Soils data provided by USDA and NRCS.

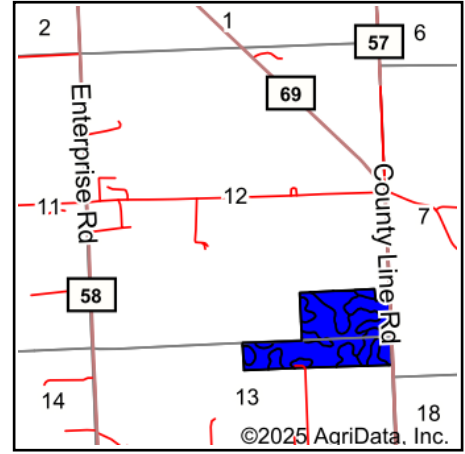

State: **Ohio**  
 County: **Preble**  
 Location: **12-5N-3E**  
 Township: **Lanier**  
 Acres: **61.25**  
 Date: **8/6/2025**



Maps Provided By:



© AgriData, Inc. 2023

www.AgriDataInc.com



Area Symbol: OH113, Soil Area Version: 23  
 Area Symbol: OH135, Soil Area Version: 23

Code	Soil Description	Acres	Percent of field	Non-Irr Class Legend	Non-Irr Class *c	Corn Bu	Grass legume hay Tons	Oats Bu	Pasture AUM	Soybeans Bu	Winter wheat Bu	*n NCCPI Soybeans	*eFOTG PI	
KnoA	Kokomo silt loam, 0 to 1 percent slopes	27.46	44.8%		llw	158	5.2		10.4	55	64	66	88	
CtA	Crosby-Celina silt loams, 0 to 2 percent slopes	12.05	19.7%		llw	139	4.6		9.1	46	62	54	81	
MfB2	Miamian-Celina silt loams, 2 to 6 percent slopes, eroded	9.12	14.9%		lle	128	4.2		8.5	45	57	48	74	
CtB	Crosby-Celina silt loams, 2 to 4 percent slopes, eroded	7.66	12.5%		llw	130	4.5		8.9	43	58	49	80	
CeB	Celina silt loam, 2 to 6 percent slopes	4.78	7.8%		lle	131	4.3	70	8.7	46	58	62	76	
MfB2	Miamian-Celina silt loams, 2 to 6 percent slopes, eroded	0.11	0.2%		lle	128	4.2		8.5	45	57	48	74	
CtA	Crosby-Celina silt loams, 0 to 2 percent slopes	0.07	0.1%		llw	139	4.6		9.1	46	62	54	81	
<b>Weighted Average</b>						<b>2.00</b>	<b>144.1</b>	<b>4.8</b>	<b>5.5</b>	<b>9.5</b>	<b>49.5</b>	<b>61.3</b>	<b>*n 58.5</b>	<b>82.6</b>

\*eftog PI: Obtained from the NRCS eFOTG (<http://efotg.sc.egov.usda.gov>)

\*n: The aggregation method is "Weighted Average using all components"

\*c: Using Capabilities Class Dominant Condition Aggregation Method

Soils data provided by USDA and NRCS.