

# Soils Map

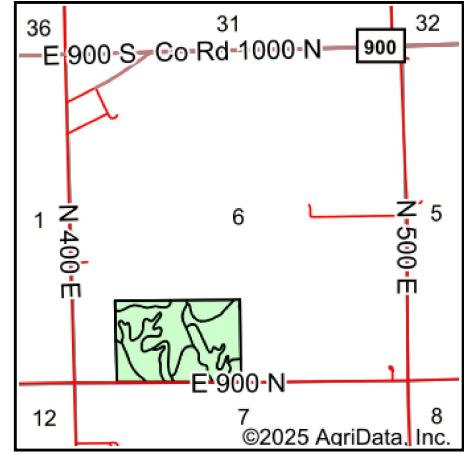

State: **Indiana**  
 County: **Randolph**  
 Location: **6-21N-15E**  
 Township: **Jackson**  
 Acres: **60.62**  
 Date: **11/13/2025**

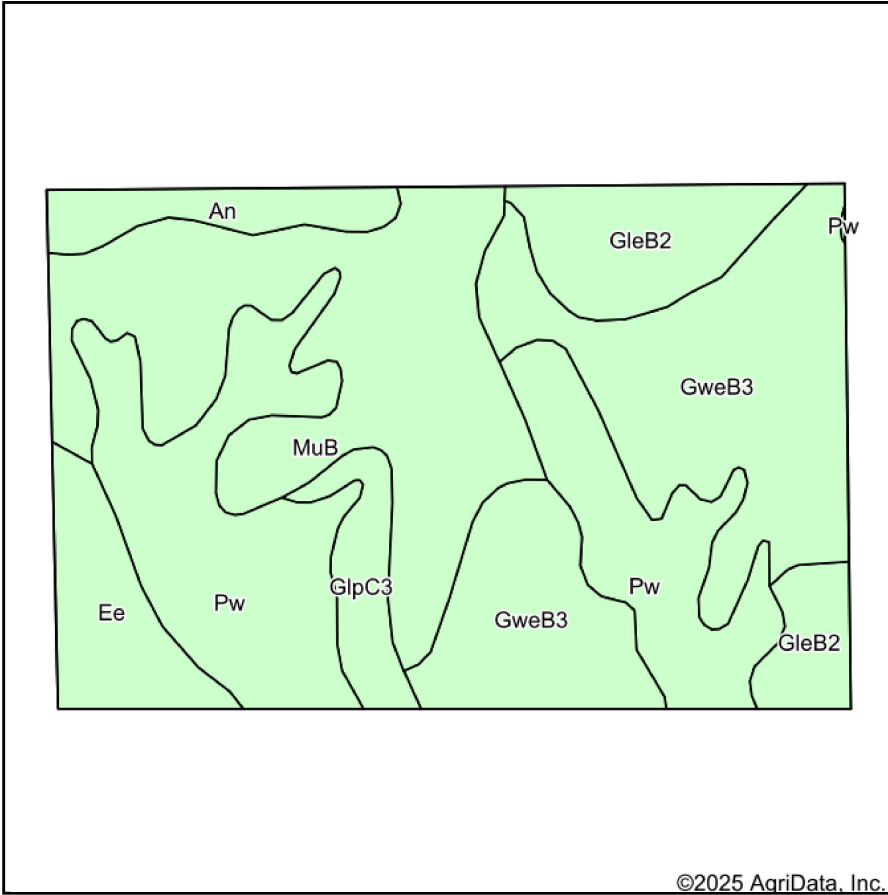

Maps Provided By:



Soils data provided by USDA and NRCS.

Area Symbol: IN135, Soil Area Version: 29

Code	Soil Description	Acres	Percent of field	Non-Irr Class *c	Corn Bu	Soybeans Bu
GweB3	Glynwood-Mississinewa clay loams, end moraine, 3 to 8 percent slopes, severely eroded	16.71	27.5%	IIIe	120	40
MuB	Morley silt loam, 3 to 6 percent slopes	15.49	25.6%	IIe	117	41
Pw	Pewamo silty clay loam, 0 to 1 percent slopes	14.85	24.5%	IIw	157	47
GleB2	Glynwood silt loam, end moraine, 1 to 4 percent slopes, eroded	5.67	9.4%	IIe	123	42
Ee	Eel silt loam, frequently flooded	3.52	5.8%	IIw	108	38
An	Allison silty clay, 0 to 2 percent slopes, frequently flooded	2.21	3.6%	IIIw	116	36
GIpC3	Glynwood clay loam, 6 to 12 percent slopes, severely eroded	2.17	3.6%	IVe	112	29
<b>Weighted Average</b>					<b>2.38</b>	<b>127.4</b>

\*c: Using Capabilities Class Dominant Condition Aggregation Method