

Soils Map

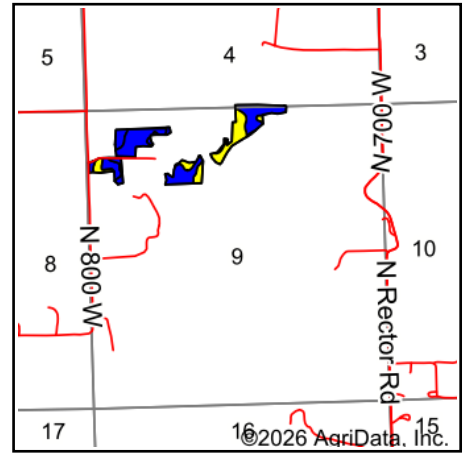

State: **Indiana**
 County: **Jefferson**
 Location: **9-4N-9E**
 Township: **Smyrna**
 Acres: **25.62**
 Date: **4/18/2026**

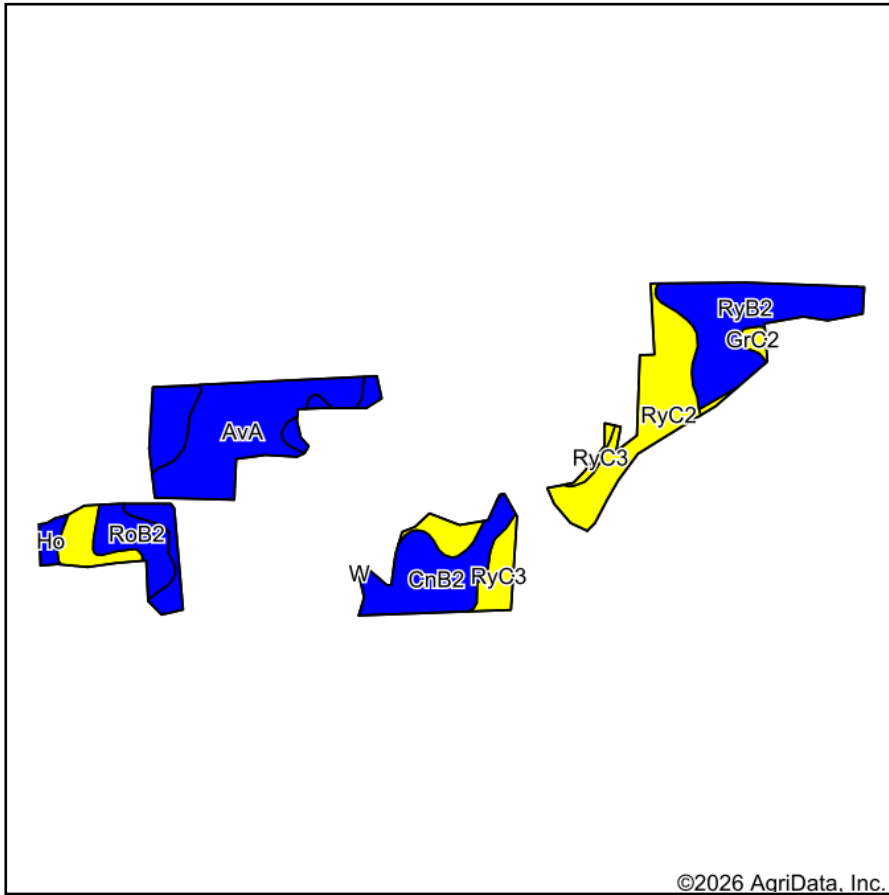

Soils data provided by USDA and NRCS.

Area Symbol: IN077, Soil Area Version: 27

Code	Soil Description	Acres	Percent of field	Non-Irr Class Legend	Non-Irr Class *c	Alfalfa hay Tons	Corn Bu	Soybeans Bu	*n NCCPI Overall	*n NCCPI Corn	*n NCCPI Small Grains	*n NCCPI Soybeans	*n NCCPI Cotton
AvA	Avonburg silt loam, 0 to 2 percent slopes	6.08	23.7%		llw		145	49	71	65	67	70	13
RyC2	Ryker silt loam, 6 to 12 percent slopes, eroded	4.87	19.0%		llle		135	47	69	69	66	58	14
RyB2	Ryker silt loam, 2 to 6 percent slopes, eroded	4.76	18.6%		lle		144	51	71	71	68	60	14
CnB2	Cincinnati silt loam, 2 to 6 percent slopes, eroded	4.02	15.7%		lle	6	130	46	53	53	51	39	
RoB2	Nabb silt loam, 2 to 6 percent slopes, eroded	2.89	11.3%		lle		130	45	60	60	58	49	
RyC3	Ryker silt loam, 6 to 12 percent slopes, severely eroded	1.22	4.8%		lIve	7	130	46	64	64	60	49	13
CnC2	Cincinnati silt loam, 6 to 12 percent slopes, eroded	1.05	4.1%		llle		114	40	45	45	41	32	
Ho	Holton loam, occasionally flooded	0.39	1.5%		llw		116	34	88	88	52	81	15

Soils data provided by USDA and NRCS.



Code	Soil Description	Acres	Percent of field	Non-Irr Class Legend	Non-Irr Class *c	Alfalfa hay Tons	Corn Bu	Soybeans Bu	*n NCCPI Overall	*n NCCPI Corn	*n NCCPI Small Grains	*n NCCPI Soybeans	*n NCCPI Cotton
GrC2	Grayford silt loam, 6 to 12 percent slopes, eroded	0.34	1.3%		Ille		115	40	63	63	61	50	12
Weighted Average					2.34	1.3	136	47.2	*n 65.3	*n 63.9	*n 61.8	*n 56	*n 9.4

*n: The aggregation method is "Weighted Average using all components"

*c: Using Capabilities Class Dominant Condition Aggregation Method