

# Soils Map

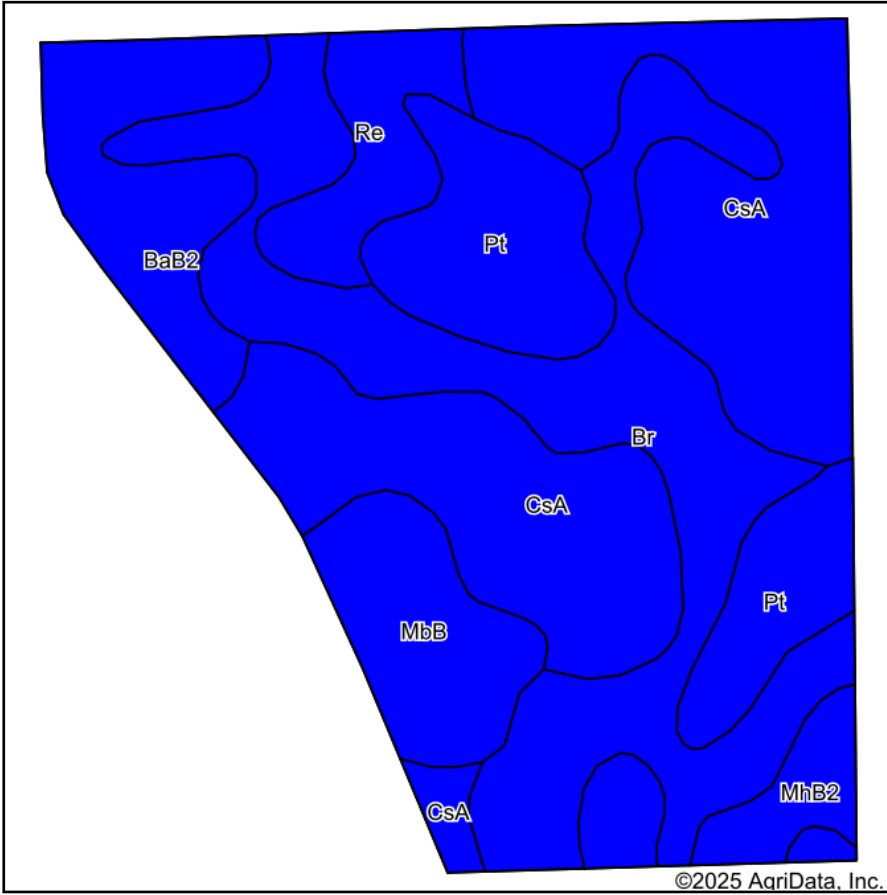

Soils data provided by USDA and NRCS.

©2025 AgriData, Inc.

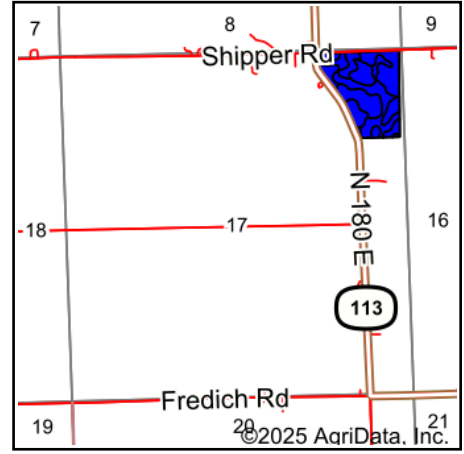

State: **Indiana**  
 County: **Wabash**  
 Location: **17-29N-7E**  
 Township: **Chester**  
 Acres: **30.06**  
 Date: **8/22/2025**



Maps Provided By:



© AgriData, Inc. 2023

www.AgriDataInc.com



Area Symbol: IN169, Soil Area Version: 29

Code	Soil Description	Acres	Percent of field	Non-Irr Class Legend	Non-Irr Class *c	Corn Bu	Soybeans Bu	*n NCCPI Overall
CsA	Crosier loam, 0 to 3 percent slopes	9.98	33.2%		IIw	140	46	66
Br	Brookston loam	8.39	27.9%		IIw	172	49	77
Pt	Pella silty clay loam	3.86	12.8%		IIw	175	49	84
BaB2	Blount loam, interlobate moraines, 1 to 4 percent slopes, eroded	2.72	9.0%		Ile	137	50	60
MbB	Martinsville loam, 2 to 6 percent slopes	2.22	7.4%		Ile	145	51	80
Re	Rensselaer loam, 0 to 1 percent slopes	1.58	5.3%		IIw	167	49	83
MhB2	Miami silt loam, 2 to 6 percent slopes, eroded	1.31	4.4%		Ile	142	49	63
<b>Weighted Average</b>					<b>2.00</b>	<b>155</b>	<b>48.2</b>	<b>*n 72.6</b>

\*n: The aggregation method is "Weighted Average using all components"

\*c: Using Capabilities Class Dominant Condition Aggregation Method

Soils data provided by USDA and NRCS.