

# Soils Map

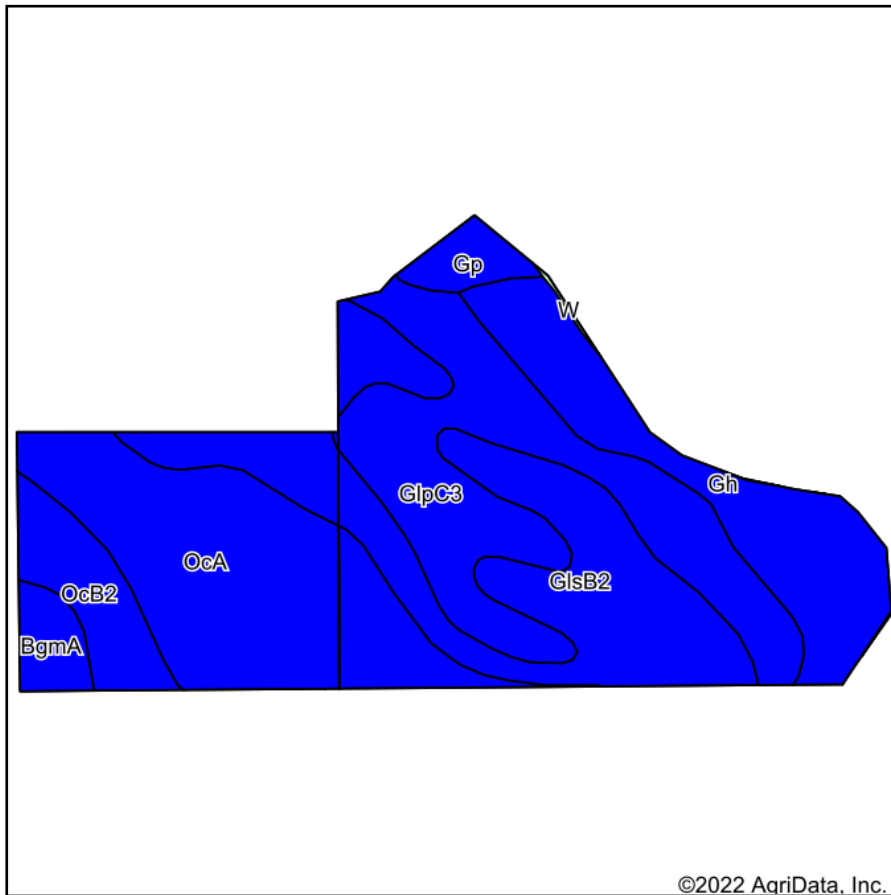

©2022 AgriData, Inc.

Soils data provided by USDA and NRCS.

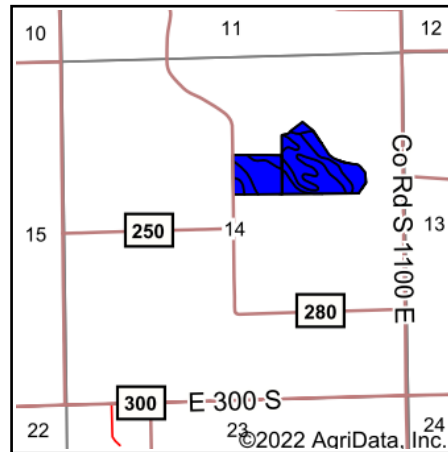

State: **Indiana**  
 County: **Howard**  
 Location: **14-23N-5E**  
 Township: **Union**  
 Acres: **31.95**  
 Date: **1/23/2022**



Maps Provided By:



© AgriData, Inc. 2021

www.AgriDataInc.com



Area Symbol: IN067, Soil Area Version: 26

Code	Soil Description	Acres	Percent of field	Non-Irr Class Legend	Non-Irr Class *c	Corn Bu	Soybeans Bu	Wheat Bu	*n NCCPI Overall
GlsB2	Glynwood silt loam, ground moraine, 2 to 6 percent slopes, eroded	7.99	25.0%		Ile	128	44		58
OcA	Ockley silt loam, 0 to 2 percent slopes	7.92	24.8%		Ie	134	47		85
GlpC3	Glynwood clay loam, 6 to 12 percent slopes, severely eroded	7.69	24.1%		IVe	112	29		51
Gh	Genesee silt loam, 0 to 2 percent slopes, occasionally flooded	4.90	15.3%		IIw	124	43	35	84
OcB2	Ockley silt loam, 2 to 6 percent slopes, eroded	1.89	5.9%		Ile	132	46		83
BgmA	Blount silt loam, ground moraine, 0 to 2 percent slopes	0.82	2.6%		IIw	141	45		70
Gp	Gravel pits	0.74	2.3%		VIII				
<b>Weighted Average</b>					<b>2.37</b>	<b>122.6</b>	<b>40.1</b>	<b>5.4</b>	<b>*n 67.4</b>

\*n: The aggregation method is "Weighted Average using all components"

\*c: Using Capabilities Class Dominant Condition Aggregation Method

Soils data provided by USDA and NRCS.