

# Soils Map

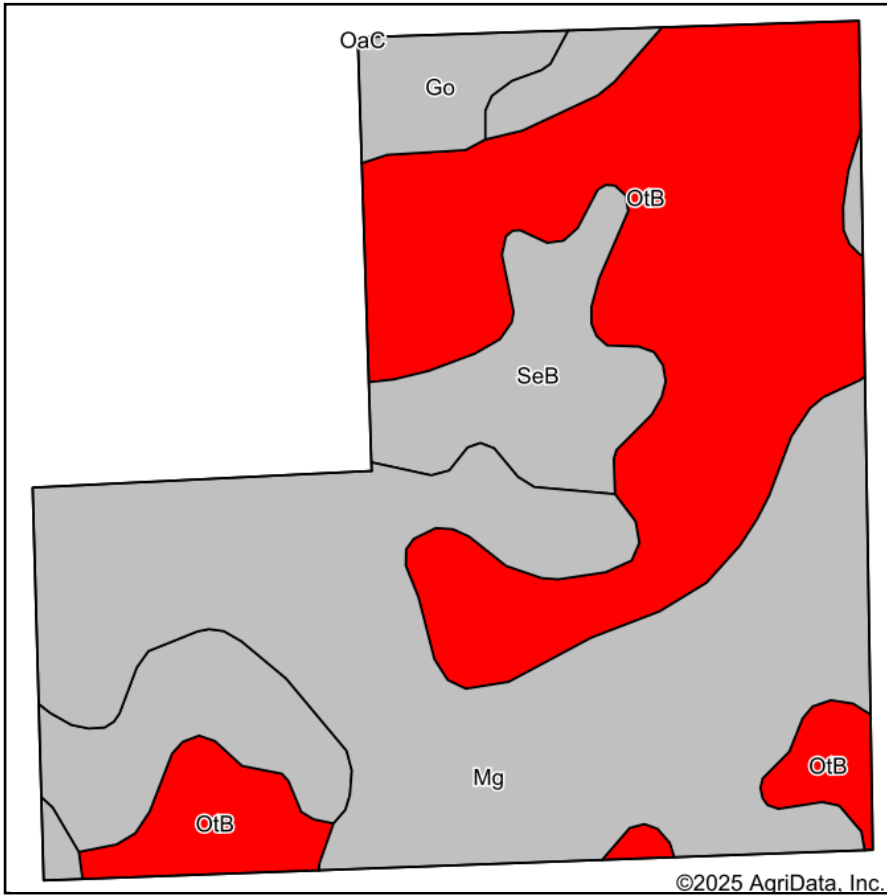

Soils data provided by USDA and NRCS.

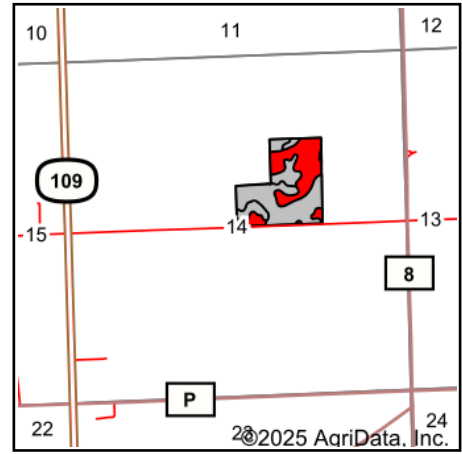

State: **Ohio**  
 County: **Henry**  
 Location: **14-5N-7E**  
 Township: **Harrison**  
 Acres: **32.43**  
 Date: **8/20/2025**



Maps Provided By:



© AgriData, Inc. 2023

www.AgriDataInc.com



Area Symbol: OH069, Soil Area Version: 20

Code	Soil Description	Acres	Percent of field	Non-Irr Class Legend	Non-Irr Class *c	Alfalfa hay Tons	Corn Bu	Soybeans Bu	*n NCCPI Soybeans	*eFOTG PI
Mg	Merrill loam, stratified substratum	14.05	43.4%		IIw		132	47	63	93
OtB	Ottokee fine sand, 1 to 5 percent slopes	12.56	38.7%		III s		86	32	27	64
SeB	Seward loamy fine sand, stratified substratum, 2 to 6 percent slopes	4.74	14.6%		IIe		86	33	45	60
Go	Gilford fine sandy loam	1.08	3.3%		IIw		126	48	45	83
<b>Weighted Average</b>					<b>2.39</b>	<b>*-</b>	<b>107.3</b>	<b>39.2</b>	<b>*n 45.8</b>	<b>76.6</b>

\*eftog PI: Obtained from the NRCS eFOTG (<http://efotg.sc.egov.usda.gov>)

\*n: The aggregation method is "Weighted Average using all components"

\*c: Using Capabilities Class Dominant Condition Aggregation Method

Soils data provided by USDA and NRCS.