

Soils Map

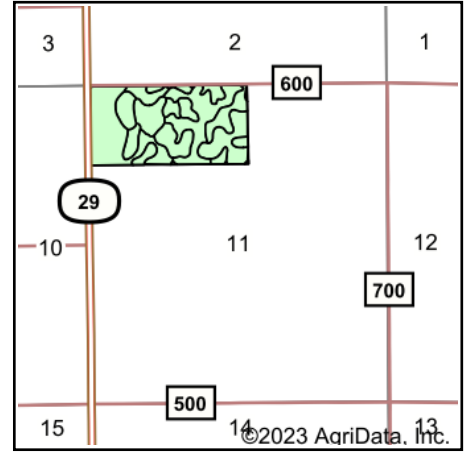

State: **Indiana**
 County: **Clinton**
 Location: **11-22N-1E**
 Township: **Warren**
 Acres: **78.77**
 Date: **6/13/2023**

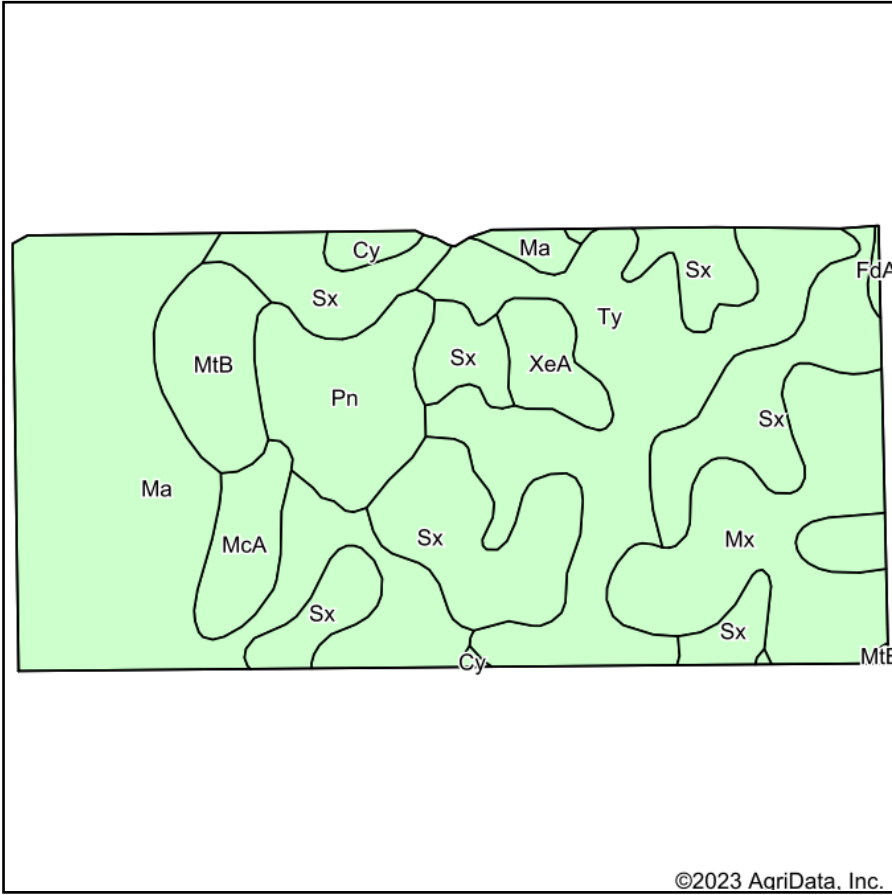

Soils data provided by USDA and NRCS.

©2023 AgriData, Inc.

Area Symbol: IN023, Soil Area Version: 26

Code	Soil Description	Acres	Percent of field	Soil Drainage	Non-Irr Class *c	Corn Bu	Soybeans Bu	Winter wheat Bu
Ma	Mahalasville silty clay loam, 0 to 2 percent slopes	20.84	26.5%	Poorly drained	Ilw	175	61	58
Sx	Starks silt loam, 0 to 2 percent slopes	19.63	24.9%	Somewhat poorly drained	Ilw	164	53	66
Ty	Treaty silt loam, 0 to 2 percent slopes	14.55	18.5%	Poorly drained	Ilw	177	62	61
Mx	Milford silty clay loam	9.20	11.7%	Very poorly drained	Ilw	160	44	64
Pn	Patton silty clay loam, 0 to 2 percent slopes	5.55	7.0%	Poorly drained	Ilw	173	51	71
MtB	Miami-Crosby silt loams, 2 to 6 percent slopes	3.75	4.8%	Moderately well drained	Ile	147	50	65
McA	Martinsville silt loam, 0 to 2 percent slopes	2.48	3.1%	Well drained	I	145	51	73
XeA	Xenia silt loam, 0 to 2 percent slopes	1.93	2.5%	Moderately well drained	Iw	154	54	69
Cy	Cyclone silt loam, 0 to 2 percent slopes	0.69	0.9%	Poorly drained	Ilw	185	65	75
FdA	Fincastle-Crosby silt loams, 0 to 2 percent slopes	0.15	0.2%	Somewhat poorly drained	Ilw	156	51	69
Weighted Average					1.94	168	55.5	63.4

*c: Using Capabilities Class Dominant Condition Aggregation Method
 Soils data provided by USDA and NRCS.