

Soils Map

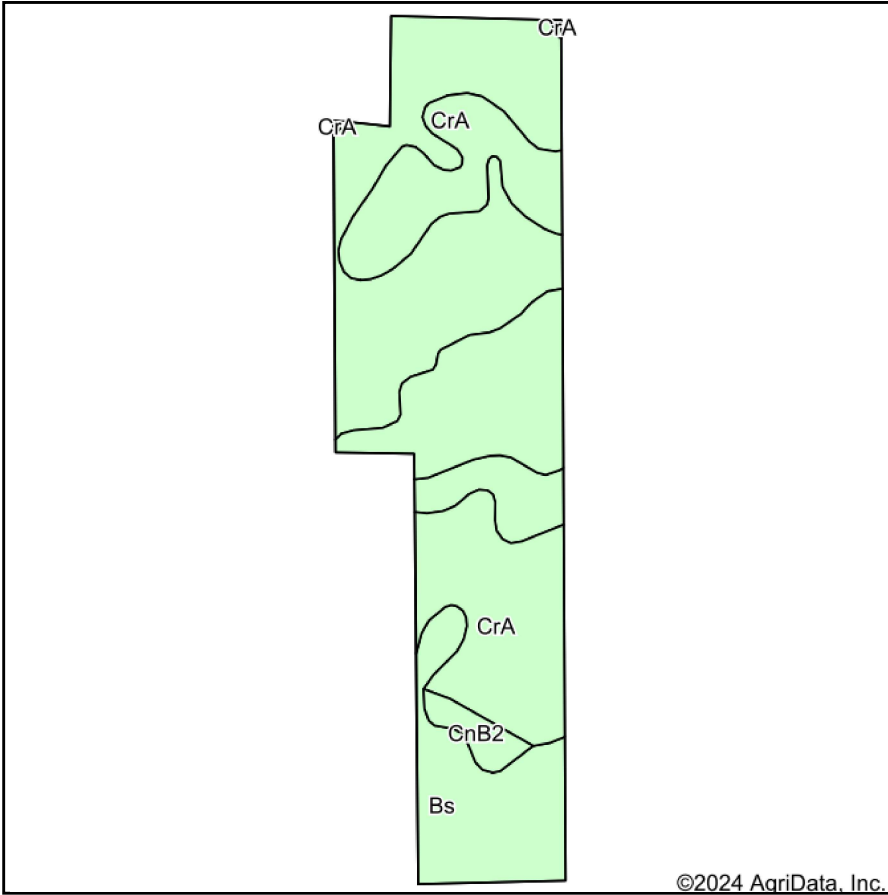

Soils data provided by USDA and NRCS.

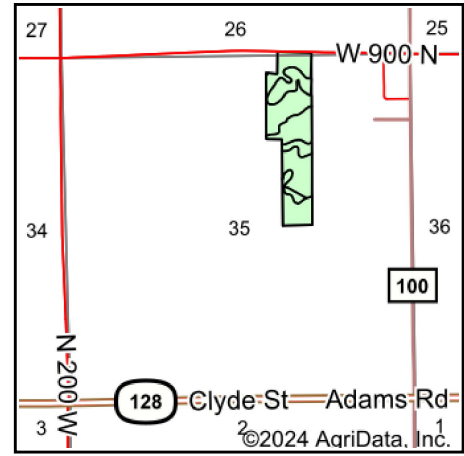

State: **Indiana**
 County: **Madison**
 Location: **35-21N-7E**
 Township: **Monroe**
 Acres: **33.87**
 Date: **12/28/2024**



Maps Provided By:



Area Symbol: IN095, Soil Area Version: 27

Code	Soil Description	Acres	Percent of field	Non-Irr Class *c	Corn Bu	Soybeans Bu
Bs	Brookston silty clay loam, 0 to 2 percent slopes	17.97	53.0%	IIw	173	51
CrA	Crosby silt loam, fine-loamy subsoil, 0 to 2 percent slopes	15.13	44.7%	IIw	155	51
CnB2	Celina silt loam, 2 to 6 percent slopes, eroded	0.77	2.3%	Ile	125	40
Weighted Average				2.00	163.9	50.7

*c: Using Capabilities Class Dominant Condition Aggregation Method