

# Soils Map

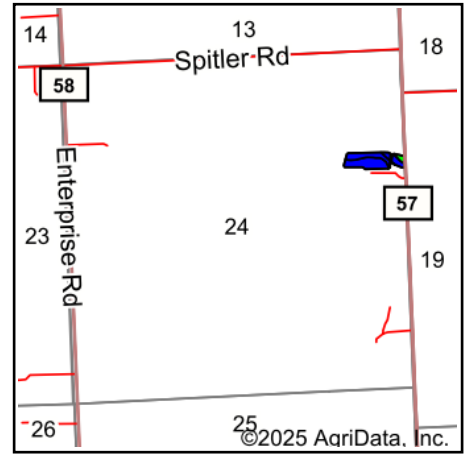

State: **Ohio**  
 County: **Preble**  
 Location: **24-5N-3E**  
 Township: **Lanier**  
 Acres: **4.81**  
 Date: **8/6/2025**

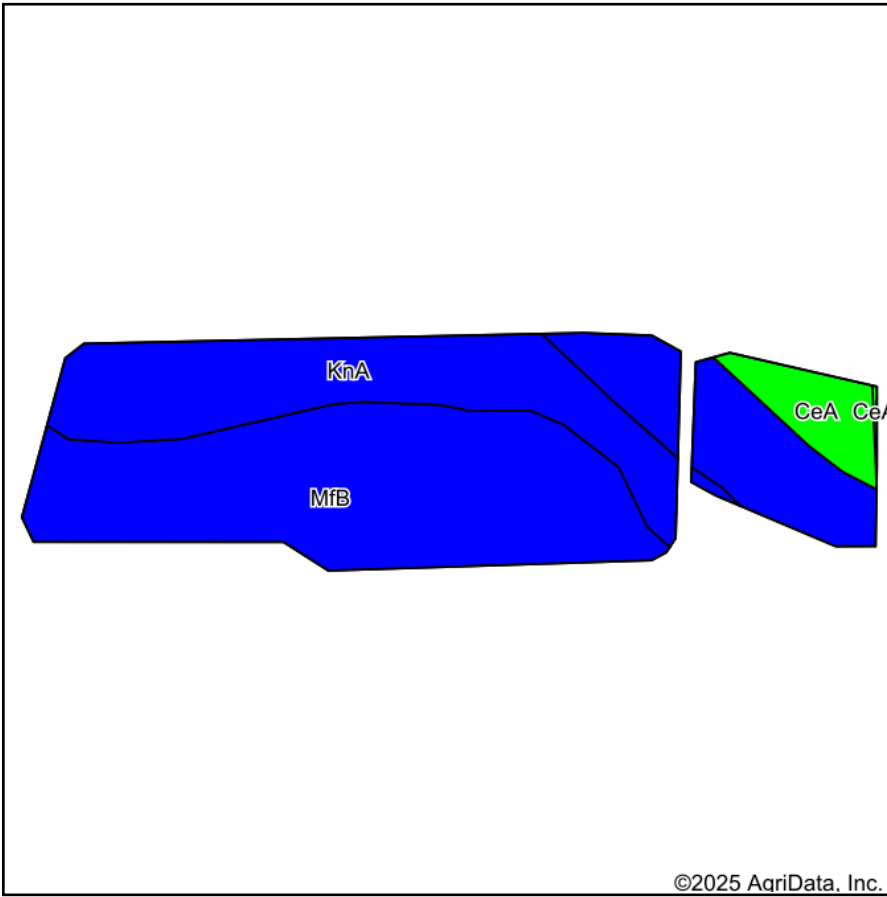

Soils data provided by USDA and NRCS.

Area Symbol: OH113, Soil Area Version: 23  
 Area Symbol: OH135, Soil Area Version: 23

Code	Soil Description	Acres	Percent of field	Non-Irr Class Legend	Non-Irr Class *c	Corn Bu	Grass legume hay Tons	Kentucky bluegrass AUM	Orchardgrass alfalfa hay Tons	Orchardgrass red clover hay Tons	Pasture AUM	Soybeans Bu	Tall fescue AUM	Winter wheat Bu	*n NCCP Soybean	
MfB	Miamian-Celina silt loams, 2 to 6 percent slopes	3.08	64.1%		Ile	124		2.8	5	4		43	3.2	61		
KnA	Kokomo silt loam, 0 to 1 percent slopes	1.44	29.9%		Ilw	158	5.2				10.4	55		64		
CeA	Celina silt loam, 0 to 2 percent slopes	0.29	6.0%		Iw	121	4.6				8.1	42		53		
<b>Weighted Average</b>						<b>1.94</b>	<b>134</b>	<b>1.8</b>	<b>1.8</b>	<b>3.2</b>	<b>2.6</b>	<b>3.6</b>	<b>46.5</b>	<b>2</b>	<b>61.4</b>	<b>*n</b>

\*eftog PI: Obtained from the NRCS eFOTG (<http://efotg.sc.egov.usda.gov>)

\*n: The aggregation method is "Weighted Average using all components"

\*c: Using Capabilities Class Dominant Condition Aggregation Method