

# Soils Map

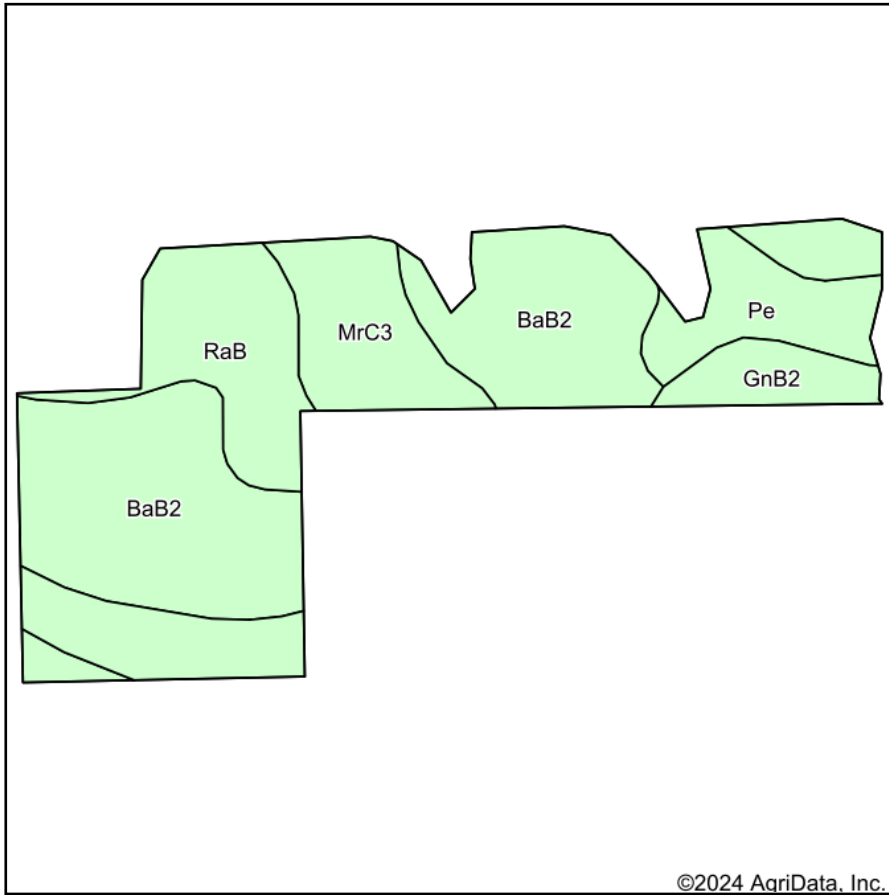

Soils data provided by USDA and NRCS.

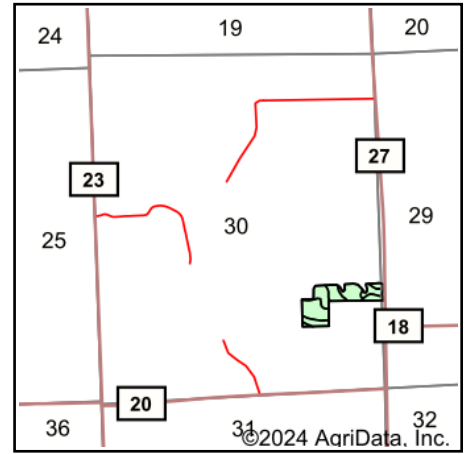

State: **Indiana**  
 County: **DeKalb**  
 Location: **30-35N-13E**  
 Township: **Smithfield**  
 Acres: **10.15**  
 Date: **9/25/2024**



Maps Provided By:



Area Symbol: IN033, Soil Area Version: 28

Code	Soil Description	Acres	Percent of field	Non-Irr Class *c	Alfalfa hay Tons	Corn Bu	Corn silage Tons	Grass legume hay Tons	Grass legume pasture AUM	Oats Bu	Pasture AUM	Soybeans Bu	Winter wheat Bu	*n NCCPI Soybeans
BaB2	Blount loam, interlobate moraines, 1 to 4 percent slopes, eroded	4.47	44.0%	Ile		137	17	5			9	50	54	45
RaB	Rawson sandy loam, 2 to 6 percent slopes	2.46	24.2%	Ile		126	18	5			8	44	57	54
MrC3	Morley silty clay loam, 6 to 12 percent slopes, severely eroded	1.34	13.2%	IVe		105	15	4	7			37	47	34
Pe	Pewamo silty clay	0.97	9.6%	IIw		155	22	5			10	42	62	59
GnB2	Glynwood loam, 2 to 6 percent slopes, eroded	0.91	9.0%	Ile	5	128	18	4	8	78		41	56	38
<b>Weighted Average</b>				<b>2.26</b>	<b>0.4</b>	<b>131</b>	<b>17.5</b>	<b>4.8</b>	<b>1.6</b>	<b>7</b>	<b>6.9</b>	<b>45.3</b>	<b>54.7</b>	<b>*n 46.4</b>

\*n: The aggregation method is "Weighted Average using all components"

\*c: Using Capabilities Class Dominant Condition Aggregation Method

Soils data provided by USDA and NRCS.