

Soils Map

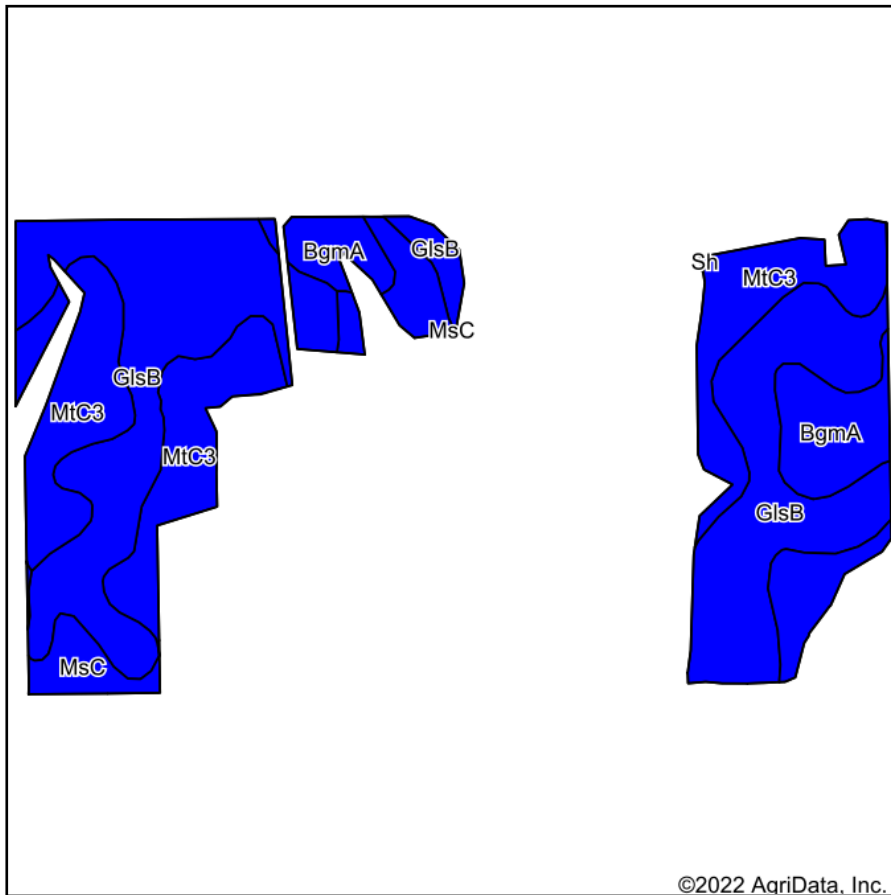

Soils data provided by USDA and NRCS.

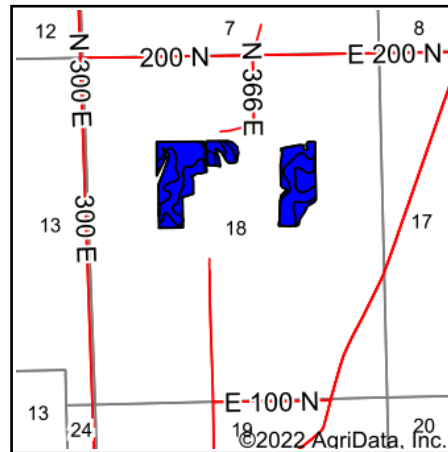

State: **Indiana**
 County: **Miami**
 Location: **18-27N-5E**
 Township: **Erie**
 Acres: **32.79**
 Date: **5/17/2022**



Maps Provided By:



Area Symbol: IN103, Soil Area Version: 25

Code	Soil Description	Acres	Percent of field	Non-Irr Class Legend	Non-Irr Class *c	Corn Bu	Soybeans Bu	*n NCCPI Overall
GlsB	Glynwood silt loam, ground moraine, 2 to 6 percent slopes	16.43	50.1%		Ile	132	46	68
MtC3	Morley silty clay loam, 6 to 12 percent slopes, severely eroded	12.10	36.9%		IVe	105	37	50
BgmA	Blount silt loam, ground moraine, 0 to 2 percent slopes	3.23	9.9%		IIw	141	45	70
MsC	Morley silt loam, 6 to 12 percent slopes	1.03	3.1%		IIIe	123	43	67
Weighted Average					2.77	122.6	42.5	*n 61.5

*n: The aggregation method is "Weighted Average using all components"

*c: Using Capabilities Class Dominant Condition Aggregation Method

Soils data provided by USDA and NRCS.