

# Soils Map

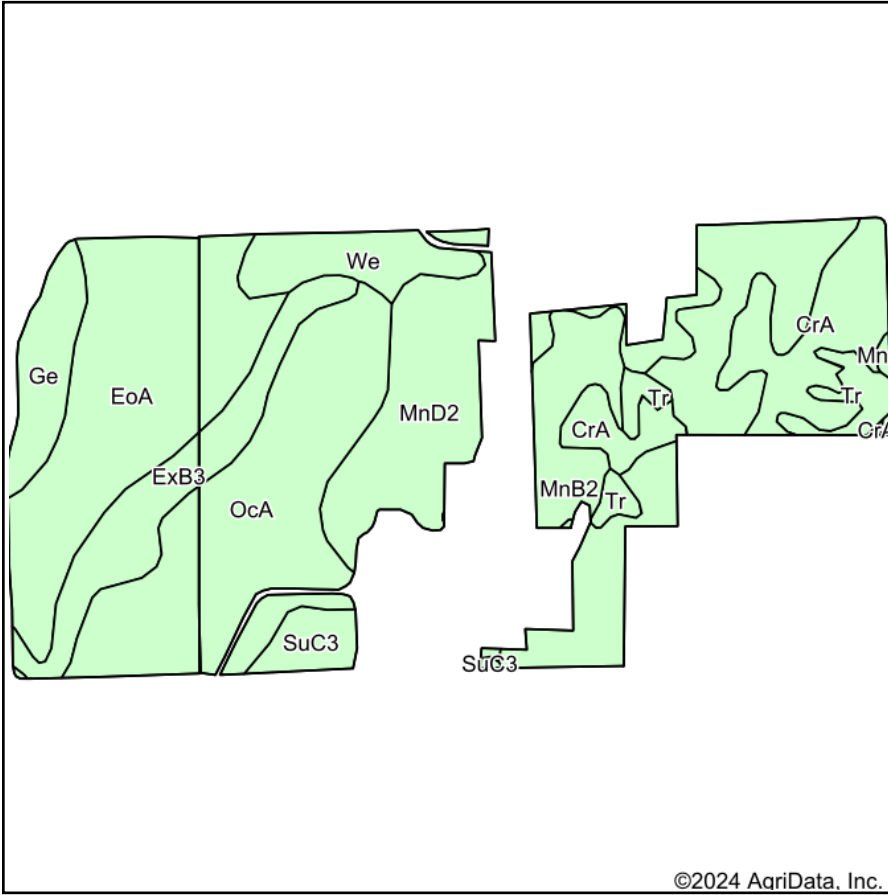

Soils data provided by USDA and NRCS.

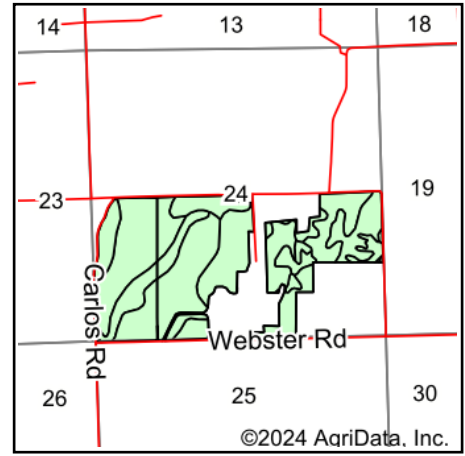

State: **Indiana**  
 County: **Wayne**  
 Location: **24-17N-13E**  
 Township: **Clay**  
 Acres: **214.37**  
 Date: **9/18/2024**



Area Symbol: IN177, Soil Area Version: 25

Code	Soil Description	Acres	Percent of field	Non-Irr Class *c	Corn Bu	Soybeans Bu
OcA	Ockley silt loam, 0 to 2 percent slopes	44.29	20.6%	I	106	38
EoA	Eldean loam, 0 to 2 percent slopes	41.32	19.3%	IIIs	115	37
MnB2	Miami silt loam, 2 to 6 percent slopes, eroded	37.91	17.7%	IIe	142	49
MnD2	Miami silt loam, well drained, 12 to 18 percent slopes, eroded	26.70	12.5%	IVe	112	38
CrA	Crosby silt loam, Southern Ohio Till Plain, 0 to 2 percent slopes	19.10	8.9%	IIW	123	41
ExB3	Eldean clay loam, 2 to 6 percent slopes, severely eroded	16.31	7.6%	IIe	82	29
We	Westland silty clay loam, 0 to 2 percent slopes	9.16	4.3%	IIW	174	49
Ge	Genesee silt loam, 0 to 2 percent slopes, occasionally flooded	8.82	4.1%	IIW	124	43
Tr	Treaty silty clay loam, 0 to 1 percent slopes	6.27	2.9%	IIW	181	64
SuC3	Strawn clay loam, 6 to 12 percent slopes, severely eroded	4.49	2.1%	IVe	121	43
<b>Weighted Average</b>				<b>2.08</b>	<b>120.7</b>	<b>40.9</b>

\*c: Using Capabilities Class Dominant Condition Aggregation Method

Soils data provided by USDA and NRCS.