

# Soils Map

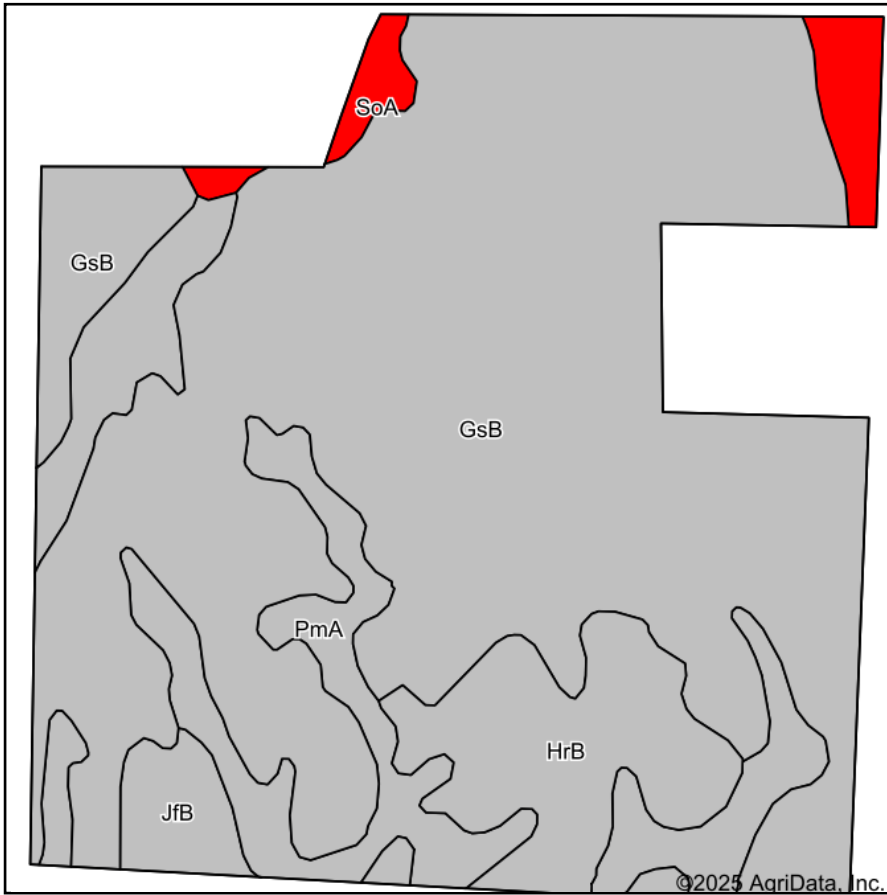

Soils data provided by USDA and NRCS.

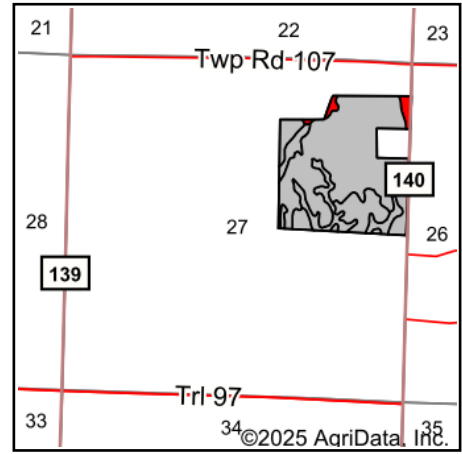

State: **Ohio**  
 County: **Hancock**  
 Location: **27-2N-10E**  
 Township: **Portage**  
 Acres: **85.96**  
 Date: **8/13/2025**



Area Symbol: OH063, Soil Area Version: 25

Code	Soil Description	Acres	Percent of field	Non-Irr Class Legend	Non-Irr Class *c	Corn Bu	Soybeans Bu	*n NCCPI Soybeans	*eFOTG PI
GsB	Glynwood-Blount-Houcktown complex, 1 to 4 percent slopes	61.42	71.6%		Ile	129	39	57	72
PmA	Pewamo silty clay loam, 0 to 1 percent slopes	12.15	14.1%		Ilw	157	47	63	84
HrB	Houcktown-Glynwood-Jenera complex, 1 to 4 percent slopes	7.94	9.2%		Ile	138	41	59	75
SoA	Sloan silty clay loam, 0 to 1 percent slopes, occasionally flooded	2.52	2.9%		Illw			73	79
JfB	Jenera-Shinrock, till substratum complex, 1 to 4 percent slopes	1.93	2.2%		Ile	138	40	63	78
<b>Weighted Average</b>					<b>2.03</b>	<b>130.2</b>	<b>39.2</b>	<b>*n 58.6</b>	<b>74.3</b>

\*eFOTG PI: Obtained from the NRCS eFOTG (<http://efotg.sc.egov.usda.gov>)

\*n: The aggregation method is "Weighted Average using all components"

\*c: Using Capabilities Class Dominant Condition Aggregation Method

Soils data provided by USDA and NRCS.